

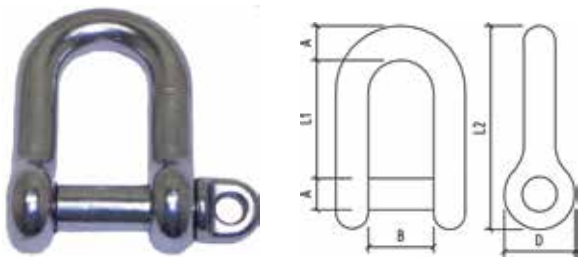

ABOVE ITEM IS AVAILABLE IN THE BRIDCO LOAD RATED RANGE OF COMPONENTS.  
SEE PAGE 48 FOR FURTHER DETAILS.  
F = FORGED

### STANDARD DEE SHACKLE

Code	A	B	D	L1	L2	B.L (kg)
SS-360F-05	4.8	10.8	9.8	18	30	1000
SS-360F-06	5.8	13.5	12	21	36	1700
SS-360-07	6.8	14.5	13.5	24.2	41.3	2000
SS-360F-08	7.6	17.3	15.9	29.7	48.2	2500
SS-360F-10	9.7	22.5	20	35.7	60	4100
SS-360F-12	11.6	27	23.7	43.1	70	5400
SS-360-16	16	32	31.8	56	95	10000
SS-360-19	19	38	37.6	66	110	15000
SS-360-25	24.7	50.4	49.7	87	148.7	23000
SS-360-32	31.2	64.4	64.6	110.1	190	26000



### CAPTIVE PIN DEE SHACKLE

Code	A	B	D	L1	L2	B.L (kg)
SS-360LK-06	5.2	13.2	11.3	22.2	36	1700
SS-360LK-08	8.2	15.8	15.7	28	48	2500
SS-360LK-10	9.9	19.8	19.2	35	58.2	4100

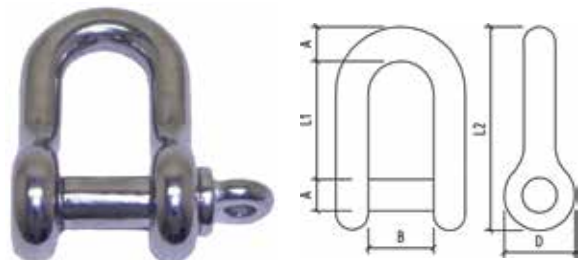

### OVERSIZE PIN DEE SHACKLE

Code	PIN	BODY	L1	B	D	L2	B.L (kg)
SS-3611-103	11.00	3/8"	31.9	15.9	23.5	57.5	4900
SS-3611-1035	12.5	7/16"	38	20.6	28	70	7300
SS-3611-104	15.7	1/2"	42.5	20.6	31.3	78	9900
SS-3611-105	19.0	5/8"	49.7	27.0	39.2	95.5	13000

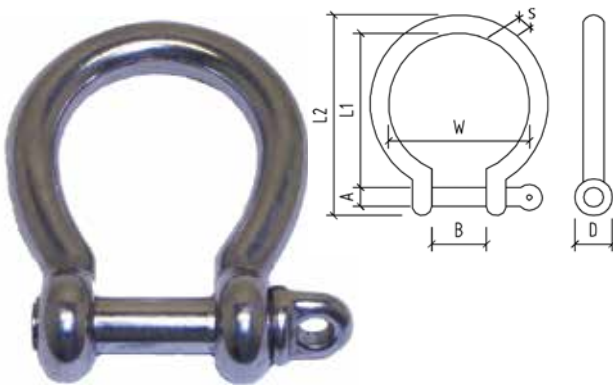

### BOW SHACKLE

Code	S	B	D	W	L1	L2	B.L (kg)
SS-370F-03	2.9	6.3	7	9.1	13	19.3	400
SS-370F-05	5	11	10	18	27	40	1200
SS-370F-06	5.8	13.6	11.9	20.6	31	46	1700
SS-370F-08	7.8	17.9	16	25.5	36.7	57	2500
SS-370F-10	9.7	20.8	20	34.1	46.75	70.7	4300
SS-370F-12	11.8	25.8	23.9	41.9	58.3	86.5	6200
SS-370-16	15.6	31.8	31.9	56	74.8	115.5	10000
SS-370-22	21.6	43.7	44	75	98	150	19000

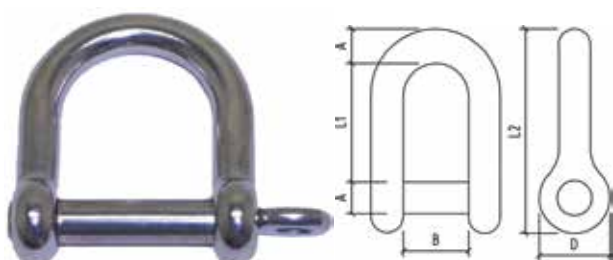

### WIDE DEE SHACKLE

Code	A	B	D	L1	L2	B.L (kg)
SS-360W-08	8	28.3	15.5	31	50	2500
SS-360W-12	11.5	49.2	23.3	64.4	92	4000

F = FORGED  
B.L = NOMINAL BREAKING LOAD

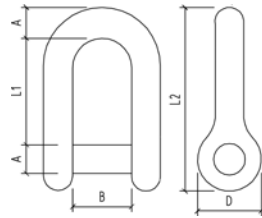

## SEMI ROUND DEE SHACKLE

Code	A	B	D	L1	L2
SS-3611-05	4.8	11.9	12	19.5	31.6
SS-3611-06	6.4	12.9	13.7	22	36.9
SS-3611-08	7.8	18	18	27.2	46.6

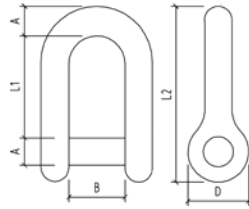

## TWISTED SHACKLE

Code	A	B	D	L1	L2	B.L (kg)
SS-380-06	5.1	13.4	11	33	46.5	1600
SS-380-08	7.7	17.4	15.4	40	59.5	2800
SS-380-10	10	20	19.7	46.8	70	4600

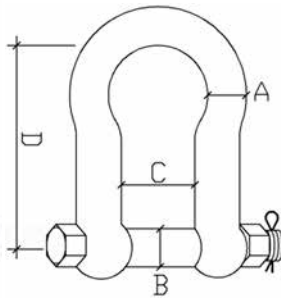

## ANCHOR SHACKLE

Code	A	B	C	D	B.L (kg)
SS-2711BB-516	5/16"	9.40	13.5	32.5	3000
SS-2711BB-38	3/8"	11.0	15.9	36.4	4800
SS-2711BB-716	7/16"	12.5	20.5	43.8	7000
SS-2711BB-58	5/8"	19.0	27.0	68.3	12000
SS-2711BB-34	3/4"	22.20	30.2	73.7	16000

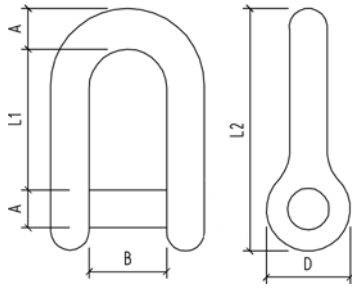

## SLOTTED HEAD DEE SHACKLE

Code	A	B	D	L1	L2	B.L (kg)
SS-360C-04	4	8	7.9	14	24	550
SS-360C-06	6	12	12	21	35	1700
SS-360C-07	7	14	14	25	42	2000
SS-360C-08	8	17	15.9	28.6	48	2800
SS-360C-10	10	20	20	35	59	4500

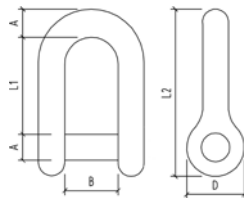

## SEMI ROUND D SLOT HEAD SHACKLE - 304 GRADE

Code	A	B	D	L1	L2	B.L (kg)
SS-361-05	5	12	12.5	19.4	30	950
SS-361-06	6	13	14	22	36	1500
SS-361-08	8	17.6	18	27	47	2600

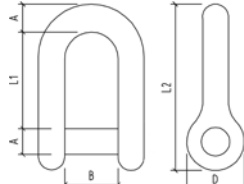

## SQUARE HEAD DEE SHACKLE

Code	A	B	D	L1	L2	B.L (kg)
SS-360B-10	10	21.3	20	35	59	4500
SS-360B-12	12	24.3	23.4	42.4	71	6000

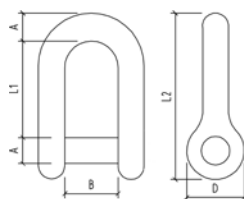

## LONG DEE SHACKLE

Code	A	B	D	L1	L2	B.L (kg)
SS-362-04	4.4	8.20	9.8	31.50	40.8	700
SS-362LK-06	5.25	11.6	12	37.5	59.2	1800
SS-362LK-08	7.1	16.0	15.9	60	80	2750
SS-362-10	10	20.0	20	74.5	99	3250
SS-362-12	12	26.60	23.7	89	118	6400

B.L = NOMINAL BREAKING LOAD

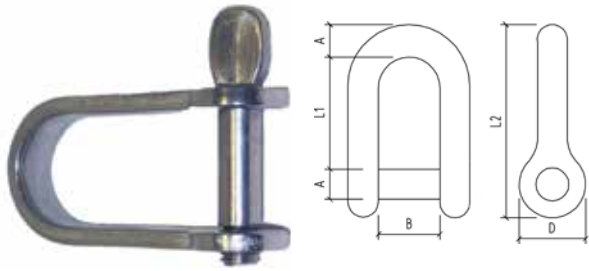

**LIGHT WEIGHT STRIP SHACKLE - 304 GRADE**

Code	A	B	D	L1	L2
SS-162-04	4	10	10	17	25

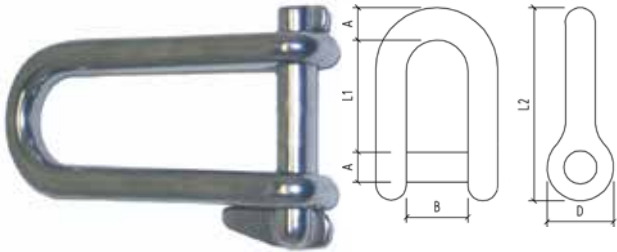

**HEAD BOARD SHACKLE CAPTIVE PIN**

Code	A	B	D	L1	L2	B.L (kg)
SS-3651-05	5	13	11	39	50	1000
SS-3651-06	6	16	12.5	43.9	57.3	1600
SS-3651-08	8	22	16.4	60	78.8	2250



**SWIVEL EYE SNAP SHACKLE**

Code	L	A	B	B.L (kg)
SS-2482-01	67.9	16	13	1100
SS-2482-02	89	24	17	2000
SS-2482-03	126	31	23	3500



**FIXED EYE SNAP SHACKLE**

Code	L	A	B	B.L (kg)
SS-2481-01	55	15	13	1100
SS-2481-02	70	22	13	2000
SS-2481-03	101	27	17	3500



**CLEW SNAP SHACKLE**

Code	A	C	L	B.L (kg)
SS-2464-02	15	18	65	1850

LARGER SIZE SHACKLES AVAILABLE IN SOME STYLES. PRICE AND AVAILABILITY ON REQUEST.



**SWIVEL EYE AND EYE**

Code	D	L	B	L1	B.L (kg)
SS-018-06	6	65	15	13	1200
SS-018-08	8	95	20.7	20	1900
SS-018-10	10	115	24	26	3500
SS-018-13	13	150	31	32	5000

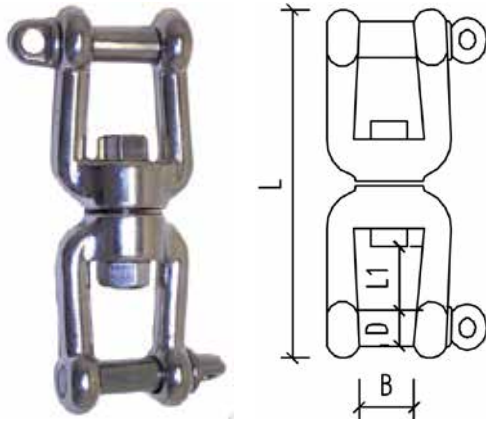

**SWIVEL JAW AND JAW**

Code	D	L	B	L1	B.L (kg)
SS-0182-06	6	66	11	11.5	1200
SS-0182-08	8	94	16	16	1900
SS-0182-10	10	118	22	22	3500
SS-0182-13	13	154	27	22	5000
SS-0182-16	16	189	32	36	8500
SS-0182-19	19	221	38	41	10000

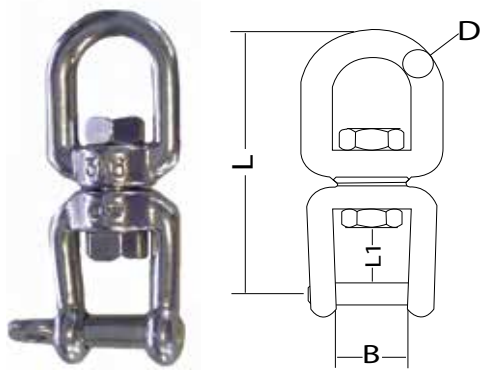

**SWIVEL JAW AND EYE**

Code	D	L	B	L1	B.L (kg)
SS-0181-06	6	60	12	11	1200
SS-0181-08	8	80	16	15	1900

**STAINLESS STEEL CLEANING AND MAINTENANCE SCHEDULE**

ENVIRONMENT	DISTANCE FROM SALT SPRAY, BEACHFRONT	CLEANING INTERVAL
MILD	15KM+	EVERY 12 MONTHS
MODERATE	1 - 15KM	EVERY 4 - 6 MONTHS
MARINE/INDUSTRIAL / URBAN	500M - SALT SPRAY / BEACHFRONT 100M - 1KM - SHELTERED BAY	EVERY 3 MONTHS
SEVERE MARINE / INDUSTRIAL / BUSY URBAN	500M - SALT SPRAY / BEACHFRONT 100M - SHELTERED BAY	WEEKLY

**STAINLESS STEEL CLEANER AND POLISH**



SHACKLES AND SWIVELS