

The following tube fittings are for use with 50.8mm/2" tube.

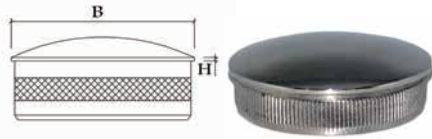

RAIL END CAP – ARCHED

CODE	TUBE	WALL (mm)	B (mm)	H (mm)	FINISH
SR-EC-50	2"	1.6	50.8	2	MIRROR
SR-EC-50S	2"	1.6	50.8	2	SATIN

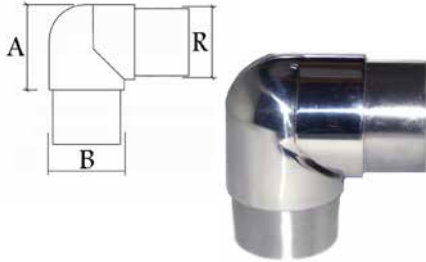

FLUSH ELBOW – ADJUSTABLE

CODE	TUBE	WALL (mm)	A (mm)	B (mm)	RAIL (mm)	FINISH
SR-AE-50	2"	1.6	57	50.8	1.6	MIRROR

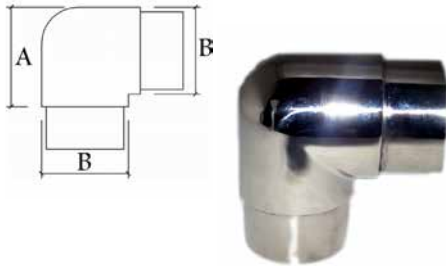

FLUSH ELBOW – FIXED – 90 DEGREE

CODE	TUBE	WALL (mm)	A (mm)	B (mm)	RAIL (mm)	FINISH
SR-FE-50	2"	1.6	57	50.8	1.6	MIRROR

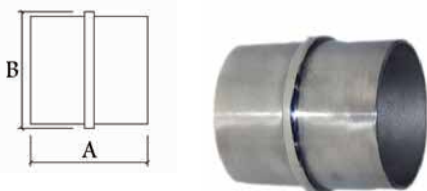

FLUSH JOINER – IN LINE

CODE	TUBE	WALL (mm)	A (mm)	B (mm)	FINISH
SR-FJ-50	2"	1.6	54	50.8	MIRROR

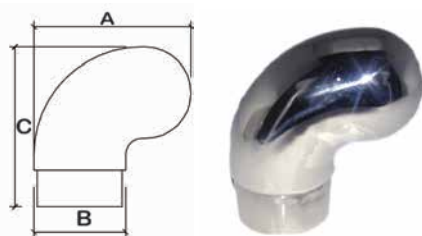

HANDRAIL – END 90 DEGREE

CODE	TUBE	WALL (mm)	A (mm)	B (mm)	C (mm)	FINISH
SR-HE90D-50	2"	1.6	89	50.8	89	MIRROR

The following tube fittings are for use with 50.8mm/2" tube.

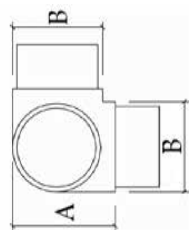

FLUSH JOINER TEE – 90 DEGREE

CODE	TUBE	WALL (mm)	A (mm)	B (mm)	FINISH
SR-FJT90-50	2"	1.6	57	50.8	MIRROR

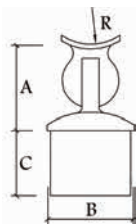

RAIL SUPPORT – ADJUSTABLE – FOR ROUND HANDRAIL

CODE	TUBE	WALL (mm)	A (mm)	B (mm)	C (mm)	R (mm)	FINISH
SR-ARS-50	2"	1.6	51	50.8	32	50.8	MIRROR

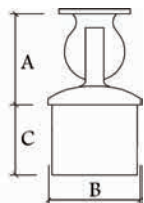

RAIL SUPPORT – ADJUSTABLE – FOR FLAT HANDRAIL

CODE	TUBE	WALL (mm)	A (mm)	B (mm)	C (mm)	FINISH
SR-ARSF-50	2"	1.6	51	50.8	32	MIRROR

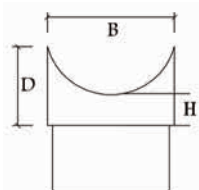

RAIL SUPPORT

CODE	TUBE	WALL (mm)	A (mm)	B (mm)	H (mm)	RAIL (mm)	FINISH
SR-RS-50	2"	1.6	32	51	10.5	50.8	MIRROR
SR-RS-50S	2"	1.6	32	51	10.5	50.8	SATIN

The following tube fittings are for use with 50.8mm/2" tube.

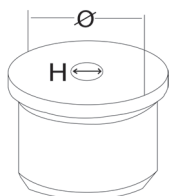

RAIL SUPPORT – CAP – DOMED

CODE	TUBE	WALL (mm)	H (mm)	Ø (mm)	FINISH
SR-RSCD-50	50.8	1.6	M8	2"	MIRROR



COUNTER SUNK SOCKET SCREW

CODE	THREAD	THREAD LENGTH
SS-CSS6010	M6	10

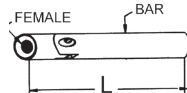

RAIL SUPPORT STEM – FIXED/SWIVEL

CODE	BAR DIA (mm)	THREAD FEMALE	THREAD MALE	L (mm)	FINISH
SR-RSSF-40	14	M6	M8	40	MIRROR
SR-RSSS-40	14	M6	M8	40	MIRROR

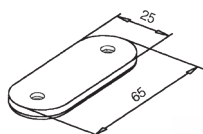

RAIL SUPPORT PLATE – FOR FLAT HANDRAIL

CODE	RAIL	FINISH
SR-RSP-00	FLAT	MIRROR

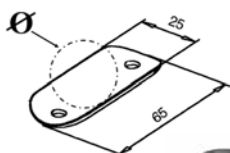

RAIL SUPPORT PLATE – FOR ROUNDED HANDRAIL

CODE	RAIL	FINISH
SR-RSP-50	50.8	MIRROR



The components above make up this handrail bracket with the option of a support plate for a flat or round handrail.

Choose the stem and rail support plate to suit your application.

All components must be ordered individually.

The following tube fittings are for use with 50.8mm/2" tube.

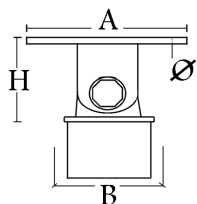

ADJUSTABLE RAIL SUPPORT – FLAT RAIL

CODE	TUBE	WALL (mm)	A (mm)	B (mm)	H (mm)	I (mm)	FINISH
SR-SQ40112	2"	1.5mm	66	50.8	50	6	MIRROR
SR-SQ40112S	2"	1.5mm	66	50.8	50	6	SATIN

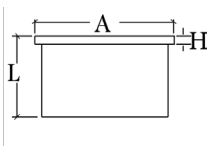

END CAP – FLAT

CODE	TUBE	WALL (mm)	A (mm)	H (mm)	L (mm)	FINISH
SR-SQ30112	2"	1.5mm	50.8	3	33	MIRROR

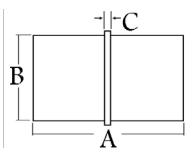

FLUSH JOINER – "IN LINE"

CODE	TUBE	WALL (mm)	A (mm)	B (mm)	C (mm)	FINISH
SR-SQ10712	2"	1.5mm	66	50.8	6	MIRROR

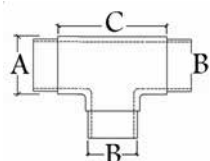

FLUSH JOINER – TEE

CODE	TUBE	WALL (mm)	A (mm)	B (mm)	C (mm)	FINISH
SR-SQ10312	2"	1.5mm	60	50.8	75	MIRROR

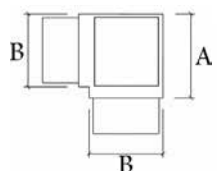

FLUSH JOINER – 90 DEGREE TEE

CODE	TUBE	WALL (mm)	A (mm)	B (mm)	FINISH
SR-SQ10512	2"	1.5mm	63	50.8	MIRROR

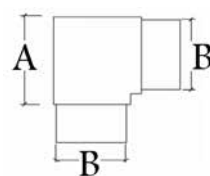

FLUSH JOINER – 90 DEGREE

CODE	TUBE	WALL (mm)	A (mm)	B (mm)	FINISH
SR-SQ10112	2"	1.5mm	63	50.8	MIRROR