

SHACKLES / SWIVELS

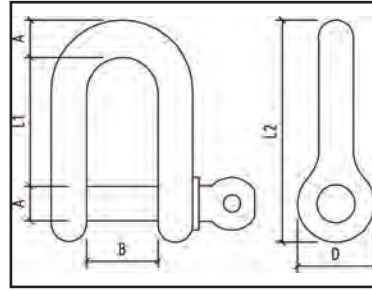

Above item is available in the Bridco Load rated range of Components
See page 42 for further details.

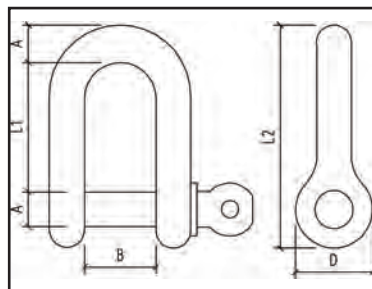
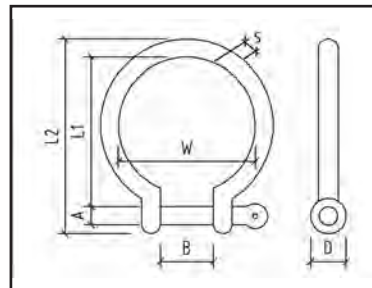
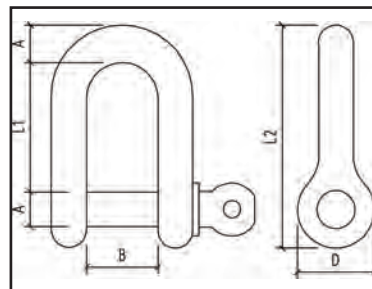
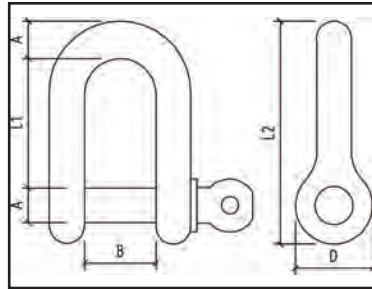

STANDARD DEE SHACKLE *AISI 316*

CODE	A	B	D	L1	L2	TDL KG
SS-360F-05	4.8	11.3	9.7	18	30	400
SS-360F-06	5.8	12	11.7	21	36	550
SS-360F-07	6.8	14.5	13.5	24.8	41.3	720
SS-360F-08	7.8	17.5	15.6	28.7	48.2	1120
SS-360F-10	9.7	21.5	20	35.7	60	1600
SS-360F-12	11.8	27	23.7	42.7	70	2400
SS-360-16	16	32	31	56	95	3600
SS-360-19	19	38	38	66	110	4400

CAPTIVE PIN DEE SHACKLE *AISI 316*

CODE	A	B	D	L1	L2	TDL KG
SS-360LK-06	5.2	11.7	11.8	21	35	550
SS-360LK-08	7.2	14.8	14.5	28	42	1120
SS-360LK-10	8.92	19.74	19.3	35	58.2	1600

DEE SHACKLE WITH OVERSIZE PIN *AISI 316*

CODE	A PIN	A BODY	L1	B	D	L2	TDL KG
SS-3611-103	10.7	9.5	31.4	15.7	23.1	57.5	2200
SS-3611-1035	12	11	38	21	28	70	2400
SS-3611-104	16	12	43	20	31	78	3600
SS-3611-105	18.6	15.4	49.7	27.5	39.2	93.5	4400

BOW SHACKLE *AISI 316*

CODE	S	B	D	BOW ID W	L1	L2	TDL KG
SS-370F-03	2.9	6.3	7	9.1	13	19.3	140
SS-370F-05	5	11	10	18	27	40	300
SS-370F-06	5.8	11	11.6	20.6	31	46	520
SS-370F-08	7.8	17.5	16	25.5	36.7	57	1050
SS-370F-10	9.5	21.8	19.5	34.1	46.4	70.7	1300
SS-370F-12	11.8	28.2	23.7	41.9	58.3	85.5	2200
SS-370-16	16	31.7	31.7	56	73.8	113.5	3375
SS-370-22	22	43	44	75	98	150	5200

WIDE DEE SHACKLE *AISI 316*

CODE	A	B	D	L1	L2	TDL KG
SS-360W-08	8	28	15	31	50	950
SS-360W-12	12	47	23	66	100	2000

F = FORGED

TDL = TESTED DEFORMATION LOAD



telephone (07) 55 935 688 fax (07) 55 935 872

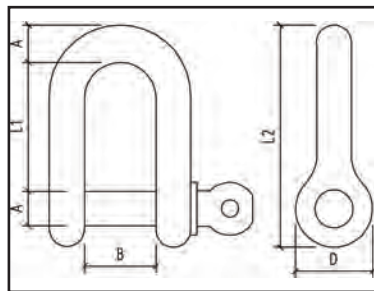

SEMI ROUND DEE SHACKLE AISI 316

CODE	A	B	D	L1	L2	TDL KG
SS-3611-05	5	12	12	19	30	400
SS-3611-06	6	13	14	22	36	550
SS-3611-08	8	18	18	29	48	1050

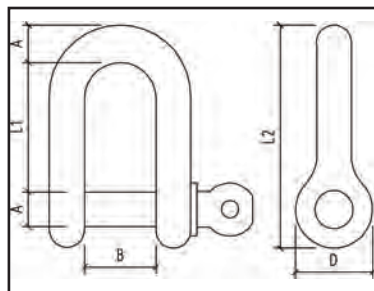

TWISTED SHACKLE AISI 316

CODE	A	B	D	L1	L2	TDL KG
SS-380-08	7.8	17.4	15.4	40	59.5	1120
SS-380-10	9.4	20	19.7	46.8	70	1600

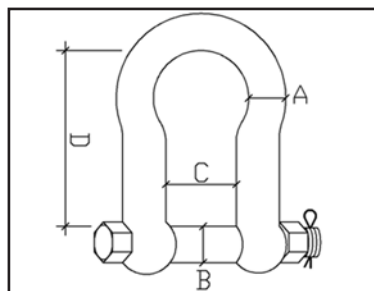

ANCHOR SHACKLE AISI 316

CODE	A	B	C	D	TDL KG
SS-2711BB-34	3/4"	21.96	29.87	73.7	8000
SS-2711BB-38	3/8"	10.97	16.30	24.39	2200
SS-2711BB-516	5/16"	9.35	13.96	32.5	1500
SS-2711BB-716	7/16"	12.52	21.64	42.87	3500

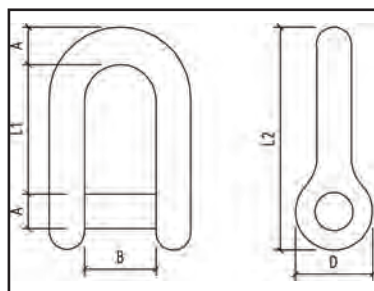

SLOTTED HEAD DEE SHACKLE AISI 316

CODE	A	B	D	L1	L2	TDL KG
SS-360C-04	4	8	7.5	14	24	280
SS-360C-06	6	12	12	21	35	550
SS-360C-07	7	14	13	24	42	720
SS-360C-08	8	17	15.6	28	47	1120
SS-360C-10	10	21	20	35	59	1600

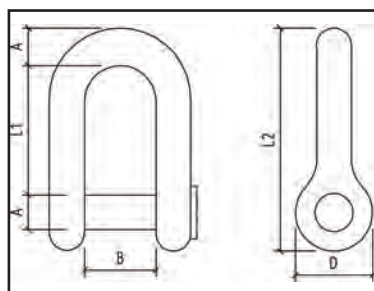

SEMI ROUND D SLOT HEAD SHACKLE AISI 304

CODE	A	B	D	L1	L2	TDL KG
SS-361-05	5	12	12	19	30	400
SS-361-06	6	13	14	22	36	550
SS-361-08	8	18	18	27	47	1120

TDL = TESTED DEFORMATION LOAD

SHACKLES / SWIVELS

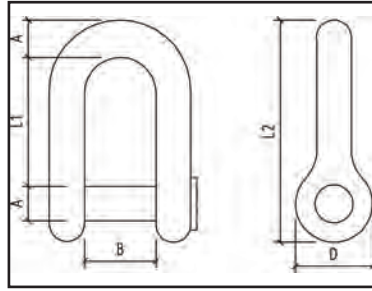

SQUARE HEAD DEE SHACKLE *AISI 316*

CODE	A	B	D	L1	L2	TDL KG
SS-360B-10	10	21	20	35.5	59	1600
SS-360B-12	12	25	23.4	41.9	71	2400

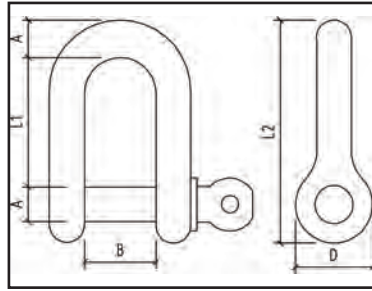

LONG DEE SHACKLE *AISI 316*

CODE	A	B	D	L1	L2	TDL KG
SS-362LK-06	5.25	11.7	11.6	45	59.2	550
SS-362LK-08	7.1	15.5	15.5	60	80	1120
SS-362-10	10	20	20	75.5	99	1600
SS-362-12	12	25	24	89	118	2400

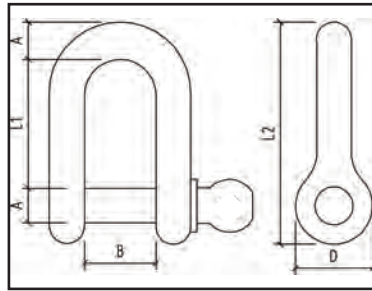

LIGHT WEIGHT STRIP SHACKLE *AISI 304*

CODE	A	B	D	L1	L2
SS-162-04	4	10	10	17	25

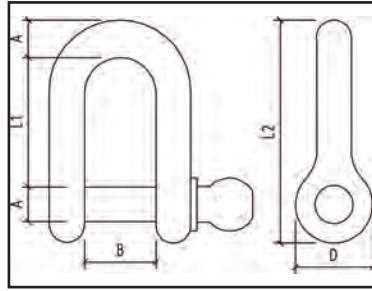

HEAD BOARD SHACKLE CAPTIVE PIN *AISI 316*

CODE	A	B	D	L1	L2	TDL KG
SS-3651-05	4.9	13	11	38.5	50	400
SS-3651-06	5.8	15.9	12.5	43	57.3	550
SS-3651-08	7.8	19.9	16.4	60	78.8	1120

TDL = TESTED DEFORMATION LOAD

Larger size shackles available in some styles. Price and availability on request.



telephone (07) 55 935 688 fax (07) 55 935 872

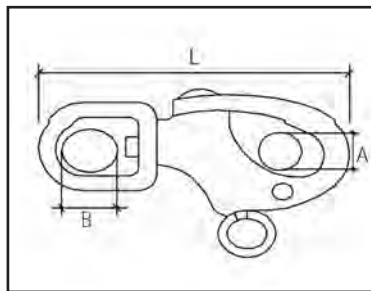

SWIVEL EYE SNAP SHACKLE <i>AISI 316</i>				
CODE	L	A	B	TDL KG
SS-2482-01	67	16	13	400
SS-2482-02	89	24	17	1200
SS-2482-03	126	31	23	1800

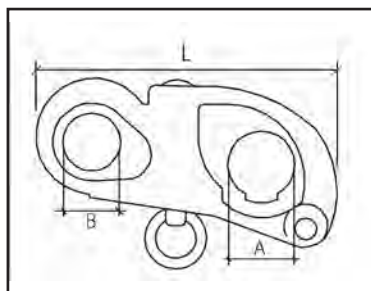

FIXED EYE SNAP SHACKLE <i>AISI 316</i>				
CODE	L	A	B	TDL KG
SS-2481-01	55	15	13	400
SS-2481-02	70	22	13	1200
SS-2481-03	101	27	17	1800

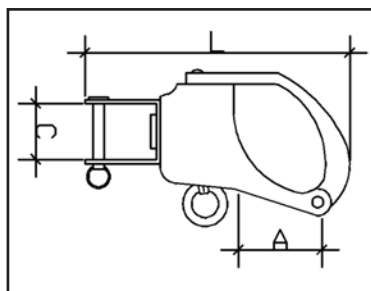

SWIVEL JAW SNAP SHACKLE <i>AISI 316</i>				
CODE	A	C	L	TDL KG
SS-2476-01	12	13	68	1100
SS-2476-02	16	15	84	2000



SPARE PARTS TO SUIT ABOVE SHACKLES	
CODE	SPARE PARTS
SS-2482-01PART	SPRING, RING & PISTON
SS-2482-02PART	SPRING, RING & PISTON
SS-2482-03PART	SPRING, RING & PISTON

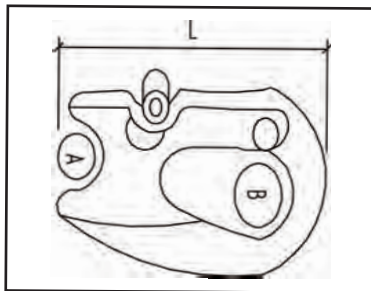

CLEW SNAP SHACKLE <i>AISI 316</i>				
CODE	L	A	B	TDL KG
SS-2464-01	52	12	15	600
SS-2464-02	65	15	18	1200

TDL = TESTED DEFORMATION LOAD

SHACKLES / SWIVELS

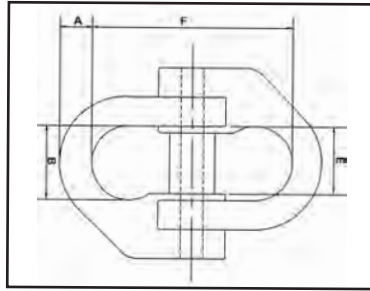

STAINLESS COUPLING LINKS								AISI 316
CODE	DIN CODE	SWL/WLL 4:1TON	CHAIN SIZE	A	B	E	F	KG
SS-015-07	7-8	1	7/8mm	9	20	19	56	0.15
SS-015-10	10	2	10mm	13	22	25	68	0.32
SS-015-13	13	3.2	13mm	17	33	30	89	0.73

The above fittings are Load Rated.
For further information see page 42.

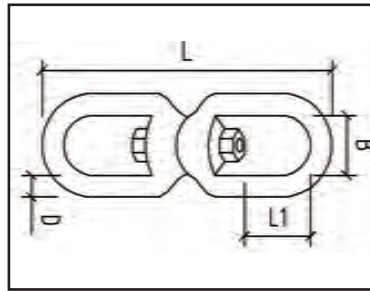

SWIVELS							AISI 316
CODE	DIA D	STYLE	L	B	L1	TDL KG	
SS-018-06	6	E/E	65	15	14	550	
SS-018-08	8	E/E	95	20.7	20	1120	
SS-018-10	8	E/E	115	24	26	1600	
SS-018-13	13	E/E	150	31	32	2700	

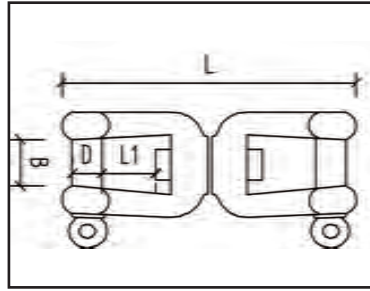
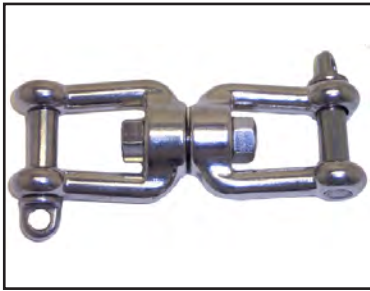

SWIVELS							AISI 316
CODE	DIA D	STYLE	L	B	L1	TDL KG	
SS-0182-06	6	J/J	66	13	11.5	550	
SS-0182-08	8	J/J	94	16	16	1120	
SS-0182-10	10	J/J	118	20	22	1600	
SS-0182-13	13	J/J	154	26	22	2700	
SS-0182-16	16	J/J	189	31	36	8500	
SS-0182-19	19	J/J	221	32	41	10000	

Stainless steel is not maintenance free, but maintenance friendly. When using stainless steel products outdoors, cleaning periodically especially in aggressive environments such as coastal areas or swimming pools, is essential. Washing regularly will reduce the risk of **tea staining**, (see introduction).

Cleaning Schedule recommended by Bridco

Environment	Distance from salt spray, beachfront or sheltered bay	Cleaning Interval
Mild	15km+	Every 12 months
Moderate	1 - 15 km	Every 4 - 6 months
Marine/Industrial/Urban	500m - salt spray / beachfront / 100m - 1km - sheltered bay	Every 3 months
Severe marine/Industrial/Busy Urban	500m - salt spray / beachfront / 100m - sheltered bay	Weekly

* For further information regarding selection, maintenance and cleaning of stainless steel products a copy of our 'Bridco User Guide and Conditions of Use for Stainless Steel Components' is available to download by visiting: www.bridco.com.au/links.html

Bridco recommend reading this brochure before selecting stainless steel products.



telephone (07) 55 935 688 fax (07) 55 935 872