

## STAINLESS STEEL MODULAR HANDRAIL SYSTEMS

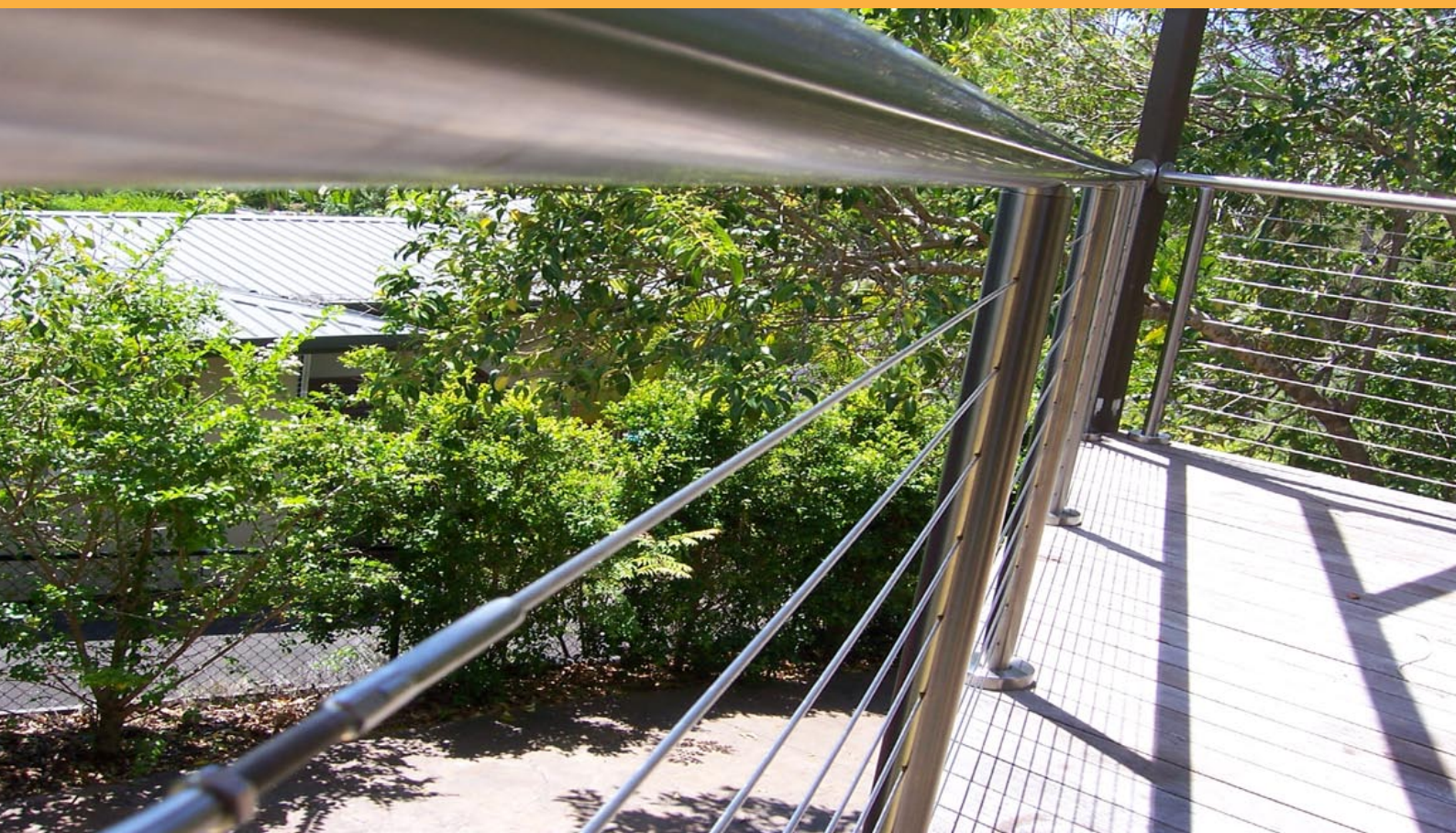

[www.bridco.com.au](http://www.bridco.com.au)





## COMPANY PROFILE

Bridco is the Registered trademark of Bridge & Company Pty Ltd, which is a family owned business first established in 1984. Bridco has since grown to become one of Australia's largest importers & exporters of quality stainless steel hardware.

Originally we were predominantly involved in the importation and wholesale supply of marine hardware, but the Company has expanded to become one of the largest suppliers of stainless steel wire rope fittings and hardware to the industrial and architectural industries. Bridco also specialise in a range of stainless steel Load Rated fittings and Grade 50, stainless steel chain & components.

Our staff comprises of personnel with extensive knowledge of the marine field, industrial lifting equipment and wire rope swaging.

Our products can be found in a wide and diverse range of industries including mining, fishing, logging, the armed forces, water & wastewater treatment plants, sewerage plants, petrochemical industries, architectural and structural engineering, playground equipment and shop fittings. Our products are widely sought after for both commercial and residential applications.





## PUBLICATION ERRORS

Although all care has been taken in the preparation and publication of this catalogue, the technical information including dimensions in illustrations, drawings and charts are non binding. Bridco does not accept any responsibility for any typographical or other errors which may have occurred during the production.

# STAINLESS STEEL FACTS

This catalogue contains a comprehensive range of quality stainless steel modular railing systems, suitable for both interior and exterior applications as well as commercial and residential projects.

**GRADES:** There are many grades of stainless steel, the majority of items in this catalogue are grade 316 with some products in grade 304 and zintec.

**ZINTEC:** Raw uncoated steel suitable for internal or external applications. These products need to be powder coated before application.

**GRADE 304:** Ideally suited to indoor use only, has good corrosion resistance and is one of the most commonly used grades of stainless steel.

**GRADE 316:** Has a higher level of corrosion resistance, therefore is most suitable to outdoor applications and for exposed coastal applications. The grade 316 is often referred to as "marine grade".

**Tea staining:** Tea staining can be defined as: discoloration of the surface of stainless steel that does not effect the structural integrity or the longevity of the material.

Contributing factors.....and what can be done about them.

The relationships between the contributing factors are complex, but generally become increasingly critical closer to marine water.

## **Environmental factors:**

Tea staining occurs most commonly within about 5 kilometers from the surf and becomes progressively worse closer to the marine source. However, wind exposure, pollution levels and high temperatures can create environments where tea staining might occur 20 kilometers or more from the sea water. These same factors also increase corrosion rates of alternative materials.

## **Surface finish:**

Rough surface finishes promote tea staining: The smoother the surface finish the better. A surface roughness (Ra) of less than 0.5 micrometers is strongly recommended, a No:4 finish is inadequate. Typically the products in this catalogue are 320 grit or higher which achieves a finish better than 0.5 micrometers (Ra).

## **Maintain regularly:**

Stainless steel is not maintenance free, but maintenance friendly. When using stainless steel material outdoors you need to clean periodically, especially in aggressive environments like coastal areas or swimming pools. Washing regularly will reduce the risk of tea staining. For best results wash with soap or a mild detergent and warm water, followed by rinsing with cold water. The appearance of the surface can be improved further if the washed surface is wiped dry.

We recommend Bridco B40 cleaner and B42 polish for the best maintenance results.

\* Material Data sheets are provided with B40 & B42.

## **Installation and inspection:**

After installation the completed structure should be washed and inspected for imperfections or contaminant's caused by the installation process. If discovered any imperfections should be cleaned off and polished with Bridco B40, followed by B42 polish. Hydrochloric acid should not be used on stainless steel as it will stain the surface and may start more serious corrosion.

The above notes have been researched by the Australian Stainless Steel Development Association (ASSDA) of which BRIDCO is a member.

Bridco will not be held responsible for any replacements at the time of publication. We recommend checking dimensions with our sales staff before purchasing Bridco products.

Bridco will not be held responsible for any errors, omissions or changes in dimensions at the time, or after publication of this catalogue.



# CONTACT US



**(07) 55 935 688**

Our office hours are:  
7.30am - 4.30pm



**(07) 55 935 872**

General Sales & Quotes

**(07) 55 936 561**

Sales - Lifting Equipment  
& Accounts



**[www.bridco.com.au](http://www.bridco.com.au)**

Visit our website for  
further details & images  
of Bridco products.

**[bridge@bridco.com.au](mailto:bridge@bridco.com.au)**

Email us.

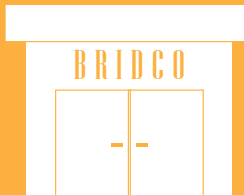

**37 Taree Street  
BURLEIGH QLD 4220**

Our warehouse is  
conveniently situated  
just 3km from the Reedy  
Creek Road exit on the  
M1

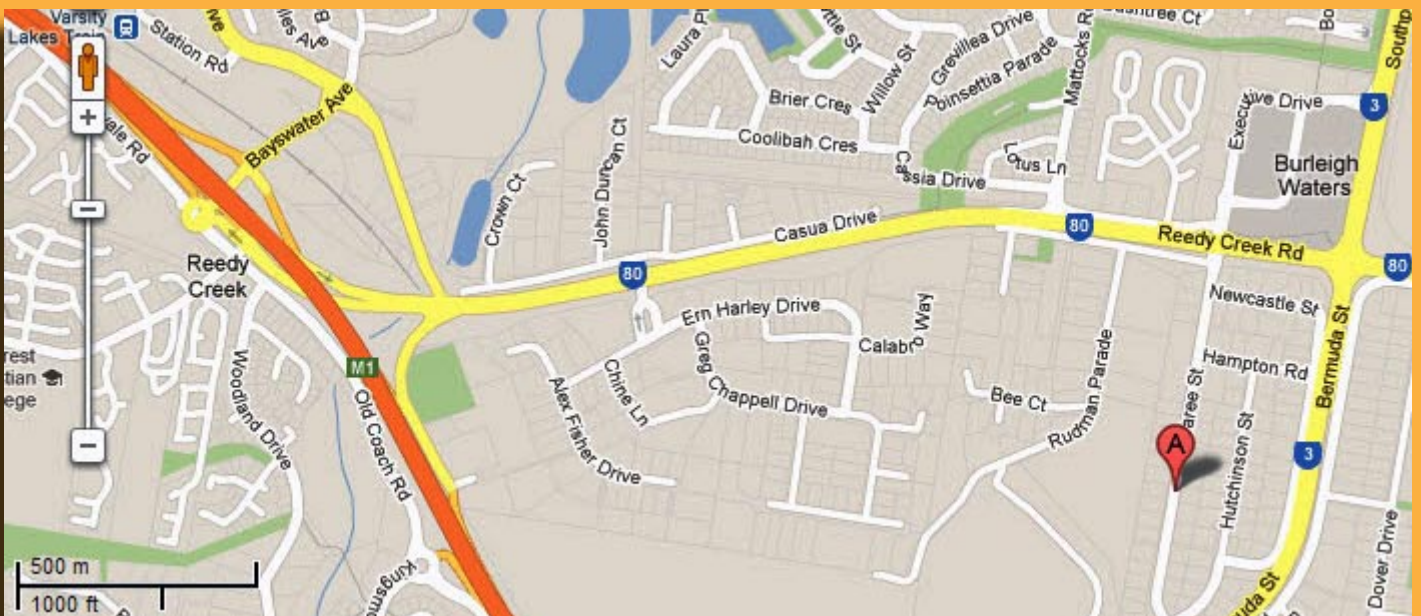

# INDEX

HANDRAIL  
BRACKETS

Pages 5 - 10

TUBE  
FITTINGS

Pages 11 - 22

POST  
FITTINGS

Pages 23 - 26

MAINTENANCE



Pages 27 - 28

ROD  
HOLDERS

Pages 29 - 32





Pages 33 - 42

GLASS  
CLAMPS



Pages 43 - 44

ADAPTERS &  
SPIGOTS

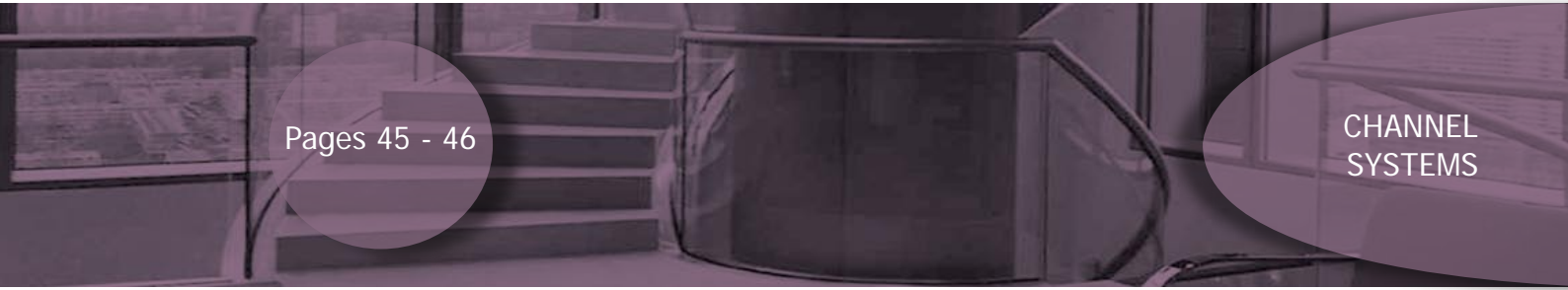

Pages 45 - 46

CHANNEL  
SYSTEMS



Pages 47 - 48

ROD &  
TUBE



Pages 49 - 54

STAINLESS  
FITTINGS

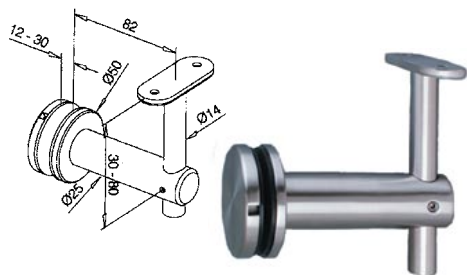

HANDRAIL BRACKET - FIXED GLASS MOUNT - FLAT HANDRAIL

| CODE           | RAIL DIA MM | FINISH |
|----------------|-------------|--------|
| AN-140150000G  | FLAT        | SATIN  |
| AN-140150000MG | FLAT        | MIRROR |

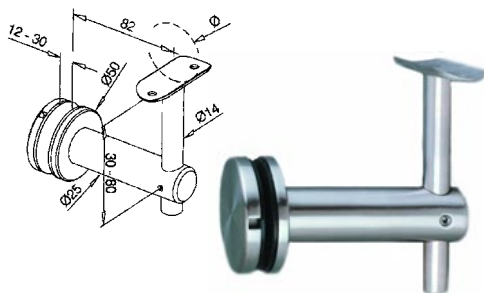

HANDRAIL BRACKET - FIXED GLASS MOUNT - ROUND HANDRAIL

| CODE           | RAIL DIA MM | FINISH |
|----------------|-------------|--------|
| AN-140150048G  | 48.3 - 50.8 | SATIN  |
| AN-140150048MG | 48.3 - 50.8 | MIRROR |

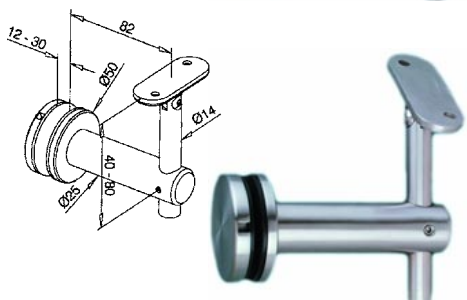

HANDRAIL BRACKET - ADJUSTABLE GLASS MOUNT - FLAT HANDRAIL

| CODE           | RAIL DIA MM | FINISH |
|----------------|-------------|--------|
| AN-140155000G  | FLAT        | SATIN  |
| AN-140155000MG | FLAT        | MIRROR |

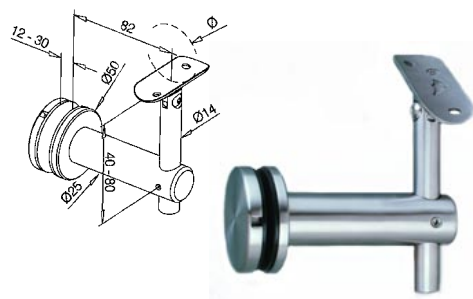

HANDRAIL BRACKET - ADJUSTABLE GLASS MOUNT - ROUND TOP RAIL

| CODE           | RAIL DIA MM | FINISH |
|----------------|-------------|--------|
| AN-140155048G  | 48.3 - 50.8 | SATIN  |
| AN-140155048MG | 48.3 - 50.8 | MIRROR |

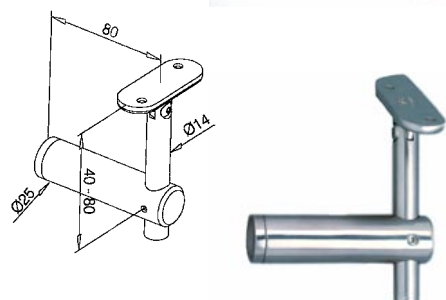

HANDRAIL BRACKET - ADJUSTABLE - FLAT RAIL

| CODE            | RAIL DIA MM | FINISH |
|-----------------|-------------|--------|
| AN-140133000G * | FLAT        | SATIN  |

\* DENOTES RUNOUT LINE.

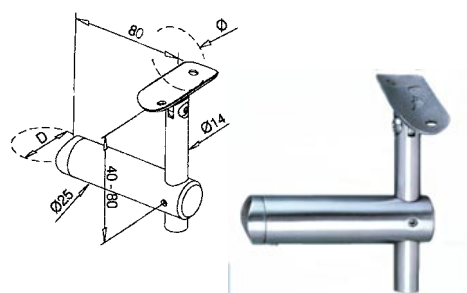

HANDRAIL BRACKET - ADJUSTABLE - ROUND RAIL

| CODE             | RAIL DIA MM | FINISH |
|------------------|-------------|--------|
| AN-140136048G *  | 48.3 - 50.8 | SATIN  |
| AN-140136048MG * | 48.3 - 50.8 | MIRROR |

\* DENOTES RUNOUT LINE.



## HANDRAIL BRACKET - FIXED WALL MOUNT - FLAT RAIL

| CODE            | RAIL DIA MM | FINISH |
|-----------------|-------------|--------|
| AN-14014000MG * | FLAT        | SATIN  |

\* DENOTES RUNOUT LINE.

## HANDRAIL BRACKET - FIXED WALL MOUNT - ROUND TOP RAIL

| CODE             | RAIL DIA MM | FINISH |
|------------------|-------------|--------|
| AN-140140048G *  | 48.3 - 50.8 | SATIN  |
| AN-140140048MG * | 48.3 - 50.8 | MIRROR |

\* DENOTES RUNOUT LINE.

## HANDRAIL BRACKET - ADJUSTABLE WALL MOUNT - FLAT RAIL

| CODE            | RAIL DIA MM | FINISH |
|-----------------|-------------|--------|
| AN-140145000G * | FLAT        | SATIN  |

\* DENOTES RUNOUT LINE.

## HANDRAIL BRACKET - ADJUSTABLE WALL MOUNT - ROUND TOP RAIL

| CODE            | RAIL DIA MM | FINISH |
|-----------------|-------------|--------|
| AN-140145048G * | 48.3 - 50.8 | SATIN  |

\* DENOTES RUNOUT LINE.

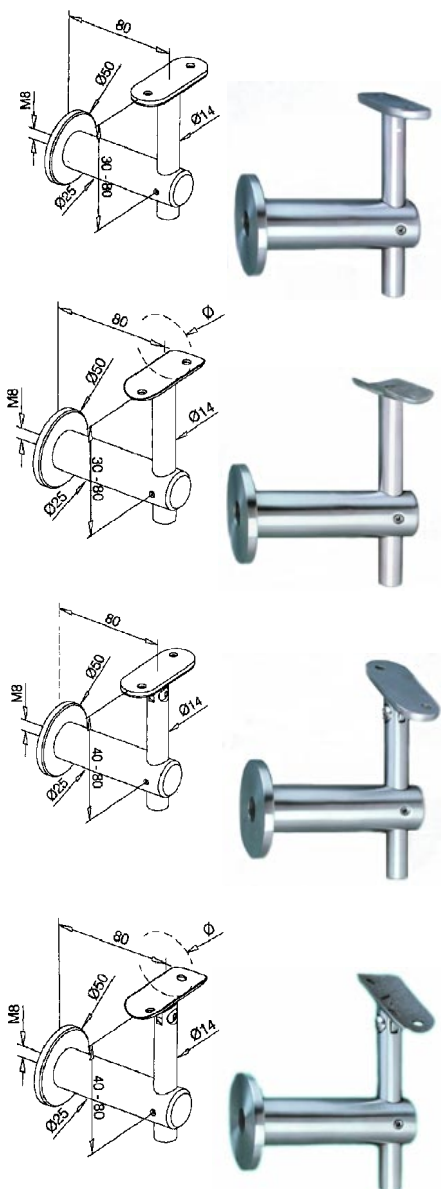

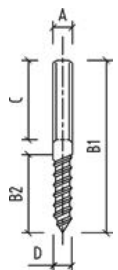

## RIGHT DOUBLE THREADED COACH SCREW AISI 316

| CODE        | A   | B1  | B2 | C  | D  |
|-------------|-----|-----|----|----|----|
| SS-78311-08 | M8  | 100 | 47 | 40 | 8  |
| SS-78311-10 | M10 | 100 | 57 | 30 | 10 |

The above item is required for securing wall mounted Handrail brackets.  
1 coach screw per bracket.

## HANDRAIL BRACKET - FIXED BOLT MOUNT - FLAT RAIL

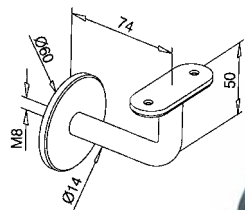

| CODE          | RAIL DIA MM | FINISH |
|---------------|-------------|--------|
| AN-140111000G | FLAT        | SATIN  |

## HANDRAIL BRACKET - FIXED BOLT MOUNT - ROUND RAIL

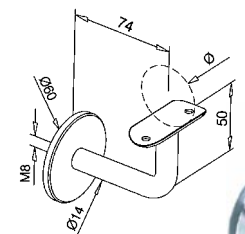

| CODE           | RAIL DIA MM | FINISH |
|----------------|-------------|--------|
| AN-140111048G  | 48.3 - 50.8 | SATIN  |
| AN-140111048MP | 48.3 - 50.8 | MIRROR |

## HANDRAIL BRACKET - FIXED WALL MOUNT - ROUND RAIL

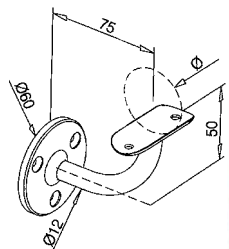

| CODE           | RAIL DIA MM | FINISH |
|----------------|-------------|--------|
| AN-1401112048G | 48.3 - 50.8 | SATIN  |

## HANDRAIL BRACKET - BOLT MOUNT - WELDED RAIL

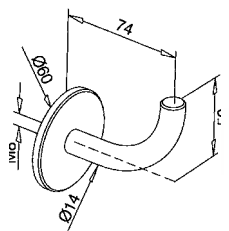

| CODE            | DESCRIPTION  | FINISH |
|-----------------|--------------|--------|
| AN-140114000G * | WALL BRACKET | SATIN  |

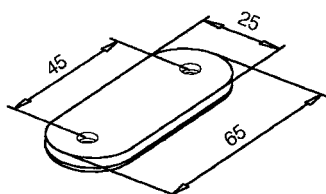



## RAIL SUPPORT - FIXED - THREADED STEM - ROUND RAIL

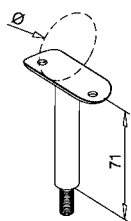

| CODE          | TUBE DIA MM | FINISH |
|---------------|-------------|--------|
| AN-140810048G | 48.3 - 50.8 | SATIN  |

## RAIL SUPPORT - ADJUSTABLE - THREADED STEM - FLAT RAIL

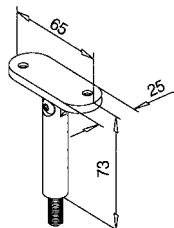

| CODE          | TUBE DIA MM | FINISH |
|---------------|-------------|--------|
| AN-140818000G | FLAT        | SATIN  |

## RAIL ADJUSTABLE - THREADED STEM - ROUND RAIL.

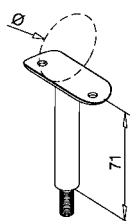

| CODE          | TUBE DIA MM | FINISH |
|---------------|-------------|--------|
| AN-140818048G | 48.3 - 50.8 | SATIN  |

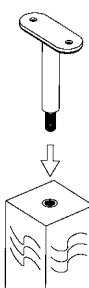

Rail supports are available with M8 or M10 threads.  
Please ensure the required thread size is available prior to ordering.

## HANDRAIL BRACKET - FLAT RAIL

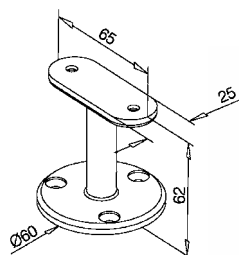

| CODE          | TUBE DIA MM | FINISH |
|---------------|-------------|--------|
| AN-140708000G | FLAT        | SATIN  |

## HANDRAIL BRACKET - ROUND RAIL

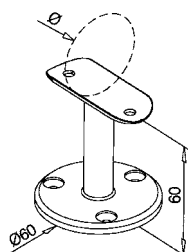

| CODE          | TUBE DIA MM | FINISH |
|---------------|-------------|--------|
| AN-140708048G | 48.3 - 50.8 | SATIN  |

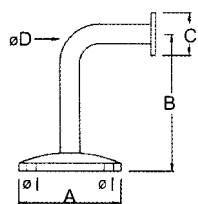

HANDRAIL SUPPORT - FIXED WALL MOUNT - FOR FLAT RAIL

| CODE       | A<br>(mm) | B<br>(mm) | C<br>(mm) | D<br>(mm) | I<br>(mm) | FINISH |
|------------|-----------|-----------|-----------|-----------|-----------|--------|
| SR-HSWM-00 | 63        | 85        | 31        | 12        | 6         | MIRROR |

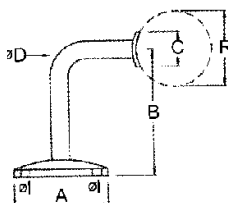

HANDRAIL SUPPORT - FIXED WALL MOUNT - FOR ROUND RAIL

| CODE       | A<br>(mm) | B<br>(mm) | C<br>(mm) | D<br>(mm) | I<br>(mm) | RAIL | FINISH |
|------------|-----------|-----------|-----------|-----------|-----------|------|--------|
| SR-HSWM-50 | 63        | 85        | 31        | 12        | 6         | 2"   | MIRROR |

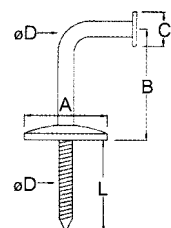

HANDRAIL SUPPORT - FIXED COACH SCREW - WALL MOUNT  
FOR FLAT RAIL

| CODE         | A<br>(mm) | B<br>(mm) | C<br>(mm) | D<br>(mm) | L<br>(mm) | FINISH |
|--------------|-----------|-----------|-----------|-----------|-----------|--------|
| SR-HSWMCS-00 | 63        | 85        | 31        | 12        | 60        | MIRROR |

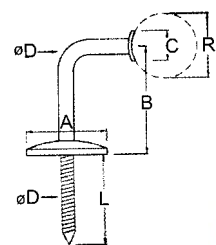

HANDRAIL BRACKET - FIXED COACH SCREW - WALL MOUNT  
FOR ROUND RAIL

| CODE         | A<br>(mm) | B<br>(mm) | C<br>(mm) | D<br>(mm) | I<br>(mm) | RAIL | FINISH |
|--------------|-----------|-----------|-----------|-----------|-----------|------|--------|
| SR-HSWMCS-50 | 63        | 85        | 31        | 12        | 60        | 2"   | MIRROR |

## HANDRAIL BRACKET RUNOUT LINES

The components listed below will be discontinued due to low demand, once stock is depleted. These components are not featured in this catalogue but have been a part of previous publications of the 'Bridco Modular Handrail Catalogue'.

| CODE           | DESCRIPTION                   | CODE           | DESCRIPTION                        |
|----------------|-------------------------------|----------------|------------------------------------|
| AN-140136000   | HANDRAIL BRACKET - FIXED      | AN-140708948   | HANDRAIL BRACKET - FIXED 90 DEGREE |
| AN-140136060   | HANDRAIL BRACKET - SWIVEL     | AN-140708960   | HANDRAIL BRACKET - FIXED 45 DEGREE |
| AN-140140000G  | HANDRAIL BRACKET - SWIVEL     | AN-140625048   | HANDRAIL BRACKET                   |
| AN-140140048MG | HANDRAIL BRACKET - FIXED      | AN-140114000MG | HANDRAIL BRACKET - BOLT MOUNT      |
| AN-140145060   | HANDRAIL BRACKET - ADJUSTABLE | AN-140113000G  | HANDRAIL BRACKET - WALL MOUNT      |
| AN-140810000   | RAIL SUPPORT - FIXED          | SR-RSP90-50    | RAIL SUPPORT PLATE 90DEGREE        |



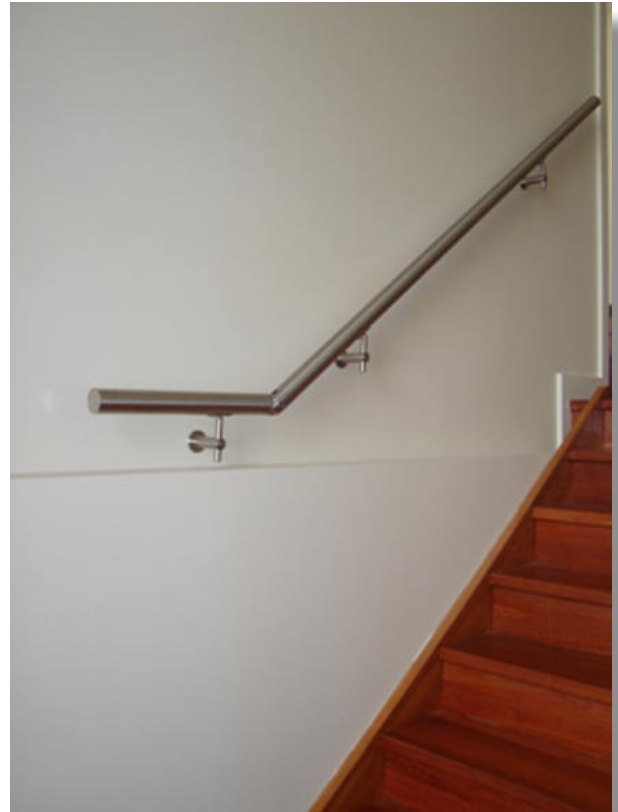
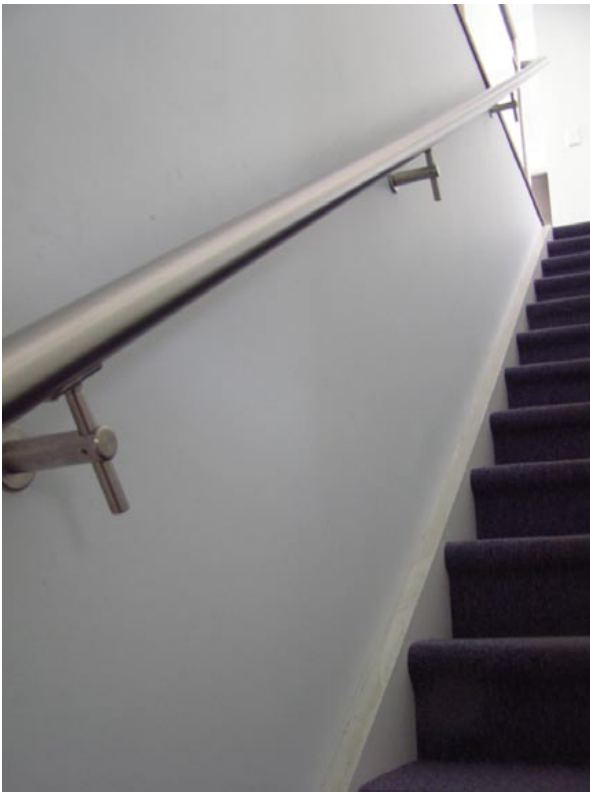

## INTERIORS



The following tube fittings are for use with 48.3mm tube.

## ELBOW JOINER 90 DEG.

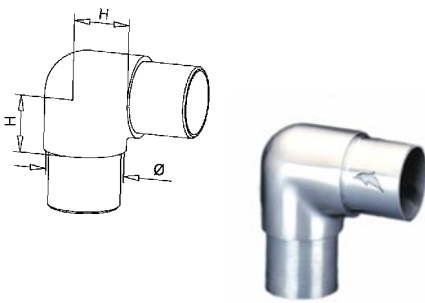

| CODE            | Ø = TUBE DIA<br>mm | H  | FINISH |
|-----------------|--------------------|----|--------|
| AN-140303048G * | 48.3 X 2.6         | 35 | SATIN  |

\* DENOTES RUNOUT LINE.

## ADJUSTABLE ELBOW JOINER

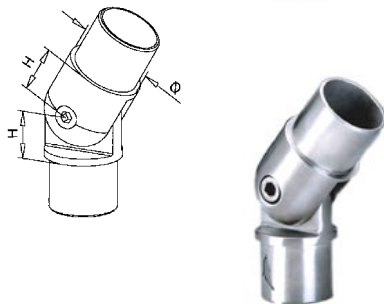

| CODE          | Ø = TUBE DIA<br>mm | H  | FINISH |
|---------------|--------------------|----|--------|
| AN-140302048G | 48.3 X 2.6         | 30 | SATIN  |

## ELBOW JOINER - CORNER POST + RAIL

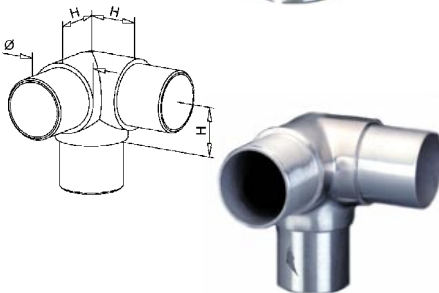

| CODE          | Ø = TUBE DIA<br>mm | H  | FINISH |
|---------------|--------------------|----|--------|
| AN-140304048G | 48.3 X 2.6         | 35 | SATIN  |

## ELBOW - 135DEGREE

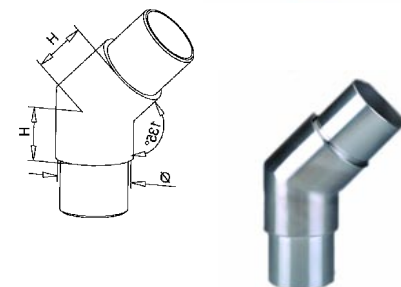

| CODE           | Ø = TUBE DIA<br>MM | H  | FINISH |
|----------------|--------------------|----|--------|
| AN-140300048 * | 48.3 X 2.6         | 35 | SATIN  |

\* DENOTES RUNOUT LINE.

## RAIL SUPPORT - ROUND RAIL

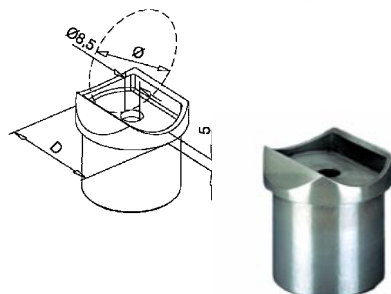

| CODE            | D = POST   | Ø = RAIL DIA | FINISH |
|-----------------|------------|--------------|--------|
| AN-140726048G * | 48.3 X 2.6 | 48.3         | SATIN  |

\* DENOTES RUNOUT LINE.

## RAIL END CAP - DOMED

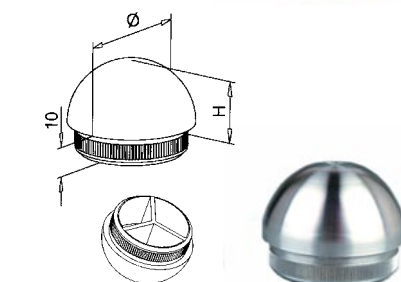

| CODE           | TUBE DIA MM | H  | FINISH |
|----------------|-------------|----|--------|
| AN-145730048 * | 48.3 X 2.6  | 24 | SATIN  |

\* DENOTES RUNOUT LINE.



## RAIL END CAP - FLAT

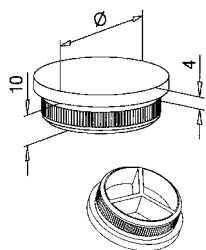

| CODE            | Ø          | FINISH |
|-----------------|------------|--------|
| AN-145732048G * | 48.3 X 2.6 | SATIN  |

\* DENOTES RUNOUT LINE.

## RAIL SUPPORT - FIXED - FLAT RAIL

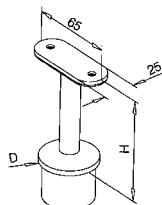

| CODE           | D = POST   | H  | FINISH |
|----------------|------------|----|--------|
| AN-140711000 * | 48.3 X 2.6 | 82 | SATIN  |

\* DENOTES RUNOUT LINE.

## RAIL SUPPORT - FIXED 90 DEG - ROUND RAIL

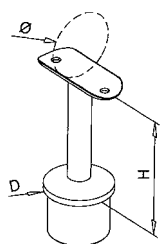

| CODE           | D = POST   | Ø    | H  | FINISH |
|----------------|------------|------|----|--------|
| AN-140711048 * | 48.3 X 2.6 | 48.3 | 80 | SATIN  |

\* DENOTES RUNOUT LINE.

## RAIL SUPPORT - FIXED 90DEGREE - ROUND RAIL

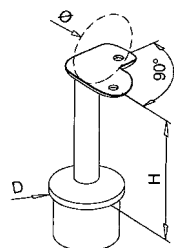

| CODE           | D = POST   | Ø    | H  | FINISH |
|----------------|------------|------|----|--------|
| AN-140711948 * | 48.3 X 2.6 | 48.3 | 80 | SATIN  |

\* DENOTES RUNOUT LINE.

## RAIL SUPPORT - ADJUSTABLE - FLAT RAIL

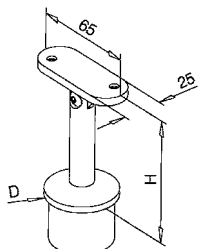

| CODE           | D = POST   | H  | FINISH |
|----------------|------------|----|--------|
| AN-140719000 * | 48.3 X 2.6 | 82 | SATIN  |

\* DENOTES RUNOUT LINE.

## RAIL SUPPORT - ADJUSTABLE - ROUND RAIL

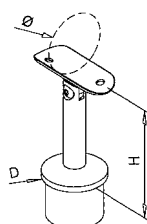

| CODE             | D = POST   | Ø    | H  | FINISH |
|------------------|------------|------|----|--------|
| AN-140719048MP * | 48.3 X 2.6 | 48.3 | 80 | MIRROR |

\* DENOTES RUNOUT LINE.

The following tube fittings are for use with 50.8mm/2" tube.

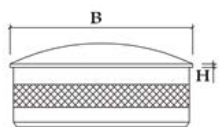

END CAP - ARCHED

| CODE      | TUBE | WALL<br>(mm) | B<br>(mm) | H<br>(mm) | FINISH |
|-----------|------|--------------|-----------|-----------|--------|
| SR-EC-50  | 2"   | 1.6          | 50.8      | 2         | MIRROR |
| SR-EC-50S | 2"   | 1.6          | 50.8      | 2         | SATIN  |

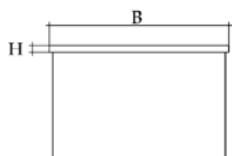

END CAP - FLAT

| CODE      | TUBE | WALL<br>(mm) | B<br>(mm) | H<br>(mm) | FINISH |
|-----------|------|--------------|-----------|-----------|--------|
| SR-ECF-50 | 2"   | 1.6          | 50.8      | 4         | MIRROR |

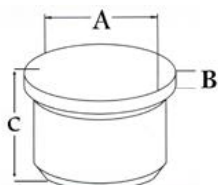

END CAP - DOMED

| CODE      | TUBE | WALL<br>(mm) | A<br>(mm) | B<br>(mm) | C<br>(mm) | FINISH |
|-----------|------|--------------|-----------|-----------|-----------|--------|
| SR-ECD-50 | 2"   | 1.6          | 50.8      | 2         | 22        | MIRROR |

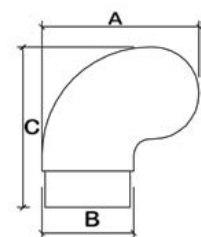

HANDRAIL END 90 DEGREE

| CODE        | TUBE | WALL<br>(mm) | A<br>(mm) | B<br>(mm) | C<br>(mm) | FINISH |
|-------------|------|--------------|-----------|-----------|-----------|--------|
| SR-HE90D-50 | 2"   | 1.6          | 89        | 50.8      | 89        | MIRROR |





The following tube fittings are for use with 50.8mm/2" tube.

## HANDRAIL END 45 DEGREE

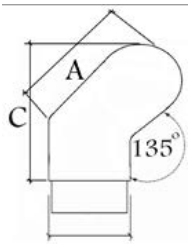

| CODE        | TUBE | WALL<br>(mm) | A<br>(mm) | B<br>(mm) | RAIL<br>(mm) | FINISH |
|-------------|------|--------------|-----------|-----------|--------------|--------|
| SR-HE45D-50 | 2"   | 1.6          | 70        | 50.8      | 1.6          | MIRROR |

## FLUSH ELBOW - ADJUSTABLE

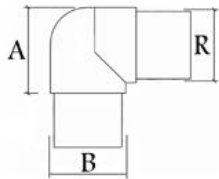

| CODE     | TUBE | WALL<br>(mm) | A<br>(mm) | B<br>(mm) | RAIL<br>(mm) | FINISH |
|----------|------|--------------|-----------|-----------|--------------|--------|
| SR-AE-50 | 2"   | 1.6          | 57        | 50.8      | 1.6          | MIRROR |

## FLUSH ELBOW - FIXED - 90 DEGREE

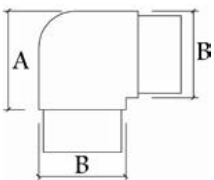

| CODE     | TUBE | WALL<br>(mm) | A<br>(mm) | B<br>(mm) | RAIL<br>(mm) | FINISH |
|----------|------|--------------|-----------|-----------|--------------|--------|
| SR-FE-50 | 2"   | 1.6          | 57        | 50.8      | 1.6          | MIRROR |

## FLUSH ELBOW - RADIUSSED - 90 DEGREE

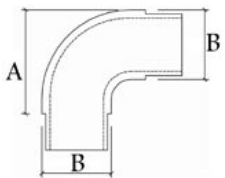

| CODE      | TUBE | WALL<br>(mm) | A<br>(mm) | B<br>(mm) | RAIL<br>(mm) | FINISH |
|-----------|------|--------------|-----------|-----------|--------------|--------|
| SR-FER-50 | 2"   | 1.6          | 66        | 50.8      | 1.6          | MIRROR |

## FLUSH JOINER - IN LINE

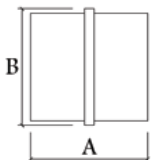

| CODE     | TUBE | WALL<br>(mm) | A<br>(mm) | B<br>(mm) | FINISH |
|----------|------|--------------|-----------|-----------|--------|
| SR-FJ-50 | 2"   | 1.6          | 54        | 50.8      | MIRROR |

## FLUSH JOINER - 135 DEGREE

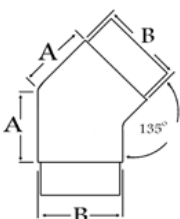

| CODE        | TUBE | WALL<br>(mm) | A<br>(mm) | B<br>(mm) | FINISH |
|-------------|------|--------------|-----------|-----------|--------|
| SR-FJ135-50 | 2"   | 1.6          | 45        | 50.8      | MIRROR |

The following tube fittings are for use with 50.8mm/2" tube.

## FLUSH JOINER TEE

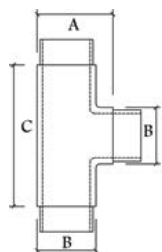

| CODE      | TUBE | WALL<br>(mm) | A<br>(mm) | B<br>(mm) | C<br>(mm) | FINISH |
|-----------|------|--------------|-----------|-----------|-----------|--------|
| SR-FJT-50 | 2"   | 1.6          | 57        | 50.8      | 67        | MIRROR |

## FLUSH JOINER TEE - 90 DEGREE

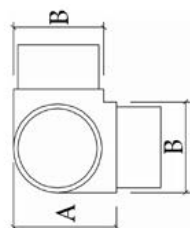

| CODE        | TUBE | WALL<br>(mm) | A<br>(mm) | B<br>(mm) | FINISH |
|-------------|------|--------------|-----------|-----------|--------|
| SR-FJT90-50 | 2"   | 1.6          | 57        | 50.8      | MIRROR |

## FLUSH JOINER TEE - 4 WAY

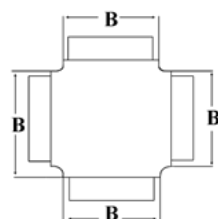

| CODE            | TUBE | WALL<br>(mm) | C<br>(mm) | B<br>(mm) | FINISH |
|-----------------|------|--------------|-----------|-----------|--------|
| SR-FJT4WAY-50 * | 2"   | 1.6          | 57        | 50.8      | MIRROR |

\* DENOTES RUNOUT LINE.

## RAIL SUPPORT - ADJUSTABLE - WALL MOUNT

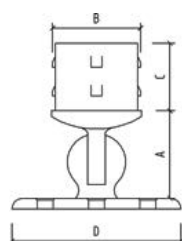

| CODE          | TUBE | WALL<br>(mm) | A<br>(mm) | B<br>(mm) | C<br>(mm) | D<br>(mm) | FINISH |
|---------------|------|--------------|-----------|-----------|-----------|-----------|--------|
| SR-ARSWM-50 * | 2"   | 1.6          | 51        | 50.8      | 26        | 101       | MIRROR |

\* DENOTES RUNOUT LINE.

## RAIL SUPPORT - ADJUSTABLE - FOR ROUND HANDRAIL

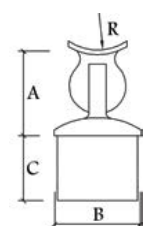

| CODE      | TUBE | WALL<br>(mm) | A<br>(mm) | B<br>(mm) | C<br>(mm) | R<br>(mm) | FINISH |
|-----------|------|--------------|-----------|-----------|-----------|-----------|--------|
| SR-ARS-50 | 2"   | 1.6          | 51        | 50.8      | 32        | 50.8      | MIRROR |

## RAIL SUPPORT - ADJUSTABLE - FOR FLAT HANDRAIL

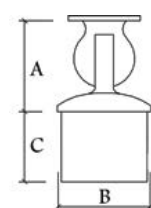

| CODE       | TUBE | WALL<br>(mm) | A<br>(mm) | B<br>(mm) | C<br>(mm) | FINISH |
|------------|------|--------------|-----------|-----------|-----------|--------|
| SR-ARSF-50 | 2"   | 1.6          | 51        | 50.8      | 32        | MIRROR |



The following tube fittings are for use with 50.8mm/2" tube.

## RAIL SUPPORT - ADJUSTABLE - EXTERNAL FIT

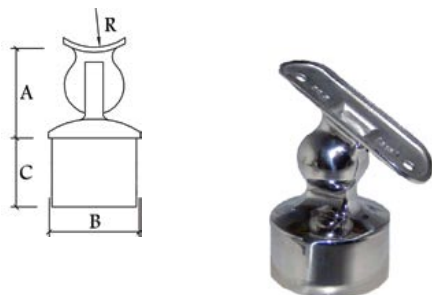

| CODE          | TUBE | WALL<br>(mm) | A<br>(mm) | B<br>(mm) | C<br>(mm) | R<br>(mm) | FINISH |
|---------------|------|--------------|-----------|-----------|-----------|-----------|--------|
| SR-ARSEXT-50  | 2"   | 1.6          | 51        | 50.8      | 32        | 50.8      | MIRROR |
| SR-ARSEXTF-50 | 2"   | 1.6          | 51        | 50.8      | 32        | FLAT      | MIRROR |

## RAIL SUPPORT - ADJUSTABLE TAPERED - FOR ROUND HANDRAIL

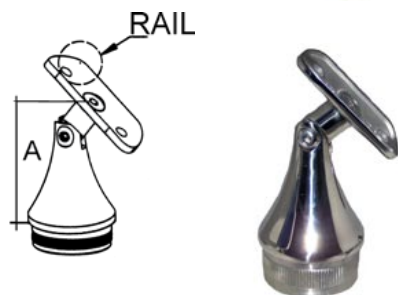

| CODE       | TUBE | WALL<br>(mm) | A<br>(mm) | RAIL<br>(mm) | FINISH |
|------------|------|--------------|-----------|--------------|--------|
| SR-RSTH-50 | 2"   | 1.6          | 78.6      | 50.8         | MIRROR |

## RAIL SUPPORT

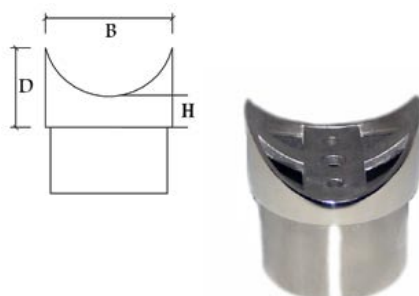

| CODE     | TUBE | WALL<br>(mm) | A<br>(mm) | B<br>(mm) | H<br>(mm) | RAIL<br>(mm) | FINISH |
|----------|------|--------------|-----------|-----------|-----------|--------------|--------|
| SR-RS-50 | 2"   | 1.6          | 32        | 51        | 10.5      | 50.8         | MIRROR |

## RAIL SUPPORT - EXTERNAL FIT - 37 DEGREE - FOR ROUND HANDRAIL

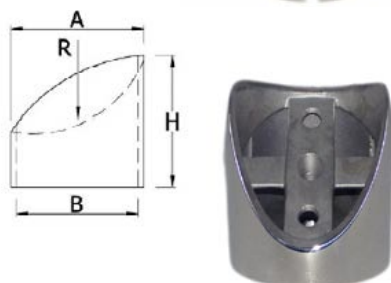

| CODE           | TUBE | A<br>(mm) | B<br>(mm) | C<br>(mm) | RAIL<br>(mm) | FINISH |
|----------------|------|-----------|-----------|-----------|--------------|--------|
| SR-RSEC37-50   | 2"   | 56        | 51.4      | 56        | 50.8         | MIRROR |
| SR-RSEC37-25 * | 1"   | 28.5      | 25.6      | 32        | 50.8         | MIRROR |

## RAIL SUPPORT - EXTERNAL FIT - FOR ROUND HANDRAIL

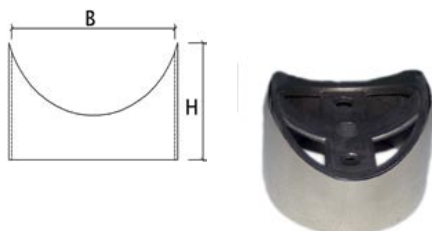

| CODE         | TUBE | B<br>(mm) | H<br>(mm) | R = RAIL<br>(mm) | FINISH |
|--------------|------|-----------|-----------|------------------|--------|
| SR-RSEC-50   | 2"   | 51.5      | 39        | 50.8             | MIRROR |
| SR-RSEC-25 * | 1"   | 26        | 17        | 50.8             | MIRROR |

\* DENOTES RUNOUT LINE.

## RAIL SUPPORT - EXTERNAL CAP - EXPANDING 37 DEGREE

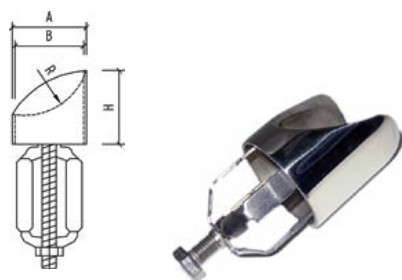

| CODE            | TUBE | A<br>(mm) | B<br>(mm) | H<br>(mm) | R<br>(mm) | FINISH |
|-----------------|------|-----------|-----------|-----------|-----------|--------|
| SR-RSEXP37-50 * | 2"   | 56        | 51        | 56        | 50.8      | MIRROR |

\* DENOTES RUNOUT LINE.

The following tube fittings are for use with 50.8mm/2" tube.

## RAIL SUPPORT - FOR FLAT HANDRAIL

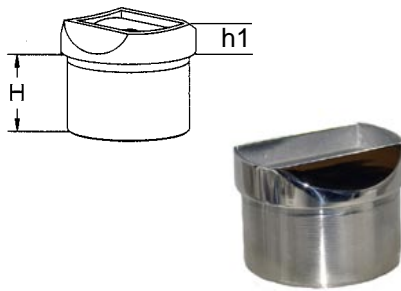

| CODE        | TUBE | WALL<br>(mm) | RAIL<br>(mm) | H<br>(mm) | h1<br>(mm) | FINISH |
|-------------|------|--------------|--------------|-----------|------------|--------|
| SR-RSF-50 * | 2"   | 1.6          | FLAT         | 25        | 12         | MIRROR |

\* DENOTES RUNOUT LINE.

## RAIL SUPPORT - FOR ROUND HANDRAIL

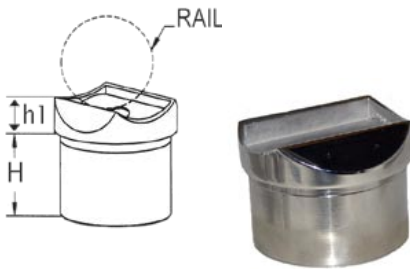

| CODE      | TUBE | WALL<br>(mm) | RAIL<br>(mm) | H<br>(mm) | h1<br>(mm) | FINISH |
|-----------|------|--------------|--------------|-----------|------------|--------|
| SR-RSR-50 | 2"   | 1.6          | 50.8         | 25        | 8          | MIRROR |

## BRIDCO USER GUIDE & CONDITIONS OF USE FOR STAINLESS STEEL COMPONENTS.

Bridco have published a four page brochure containing important information for users of stainless steel components.

The user guide cover such issues as cleaning & maintenance, stainless steel grades, corrosion resistance & environmental factors.

Bridco recommend reading this guide before purchasing or selling stainless steel fittings and / or components.

To obtain a copy of the user guide please contact our sales department, alternatively a copy can be downloaded by visiting our website: [www.bridco.com/links.html](http://www.bridco.com/links.html)





The following tube fittings are for use with 50.8mm/2" tube.

## RAIL SUPPORT CAP - DOMED

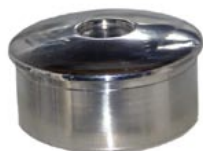
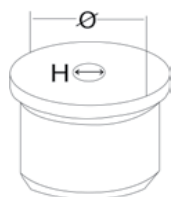

| CODE       | TUBE | WALL<br>(mm) | H<br>(mm) | O<br>(mm) | FINISH |
|------------|------|--------------|-----------|-----------|--------|
| SR-RSCD-50 | 50.8 | 1.6          | M8        | 2"        | MIRROR |

## COUNTER SUNK SOCKET SCREW



| CODE       | THREAD | THREAD<br>LENGTH |
|------------|--------|------------------|
| SS-CSS6010 | M6     | 10               |

## RAIL SUPPORT STEM - FIXED / SWIVEL

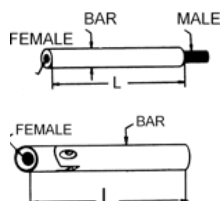

| CODE       | BAR DIA<br>(mm) | THREAD<br>FEMALE | THREAD<br>MALE | L<br>(mm) | FINISH |
|------------|-----------------|------------------|----------------|-----------|--------|
| SR-RSSF-40 | 14              | M6               | M8             | 40        | MIRROR |
| SR-RSSS-40 | 14              | M6               | M8             | 40        | MIRROR |
| SR-RSSS-75 | 14              | M6               | M8             | 75        | MIRROR |

## RAIL SUPPORT PLATE - FOR FLAT HANDRAIL

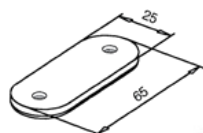

| CODE      | RAIL | FINISH |
|-----------|------|--------|
| SR-RSP-00 | FLAT | MIRROR |

## RAIL SUPPORT PLATE - FOR ROUND HANDRAIL

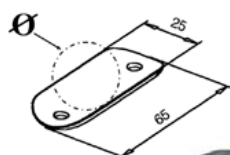

| CODE      | RAIL | FINISH |
|-----------|------|--------|
| SR-RSP-50 | 50.8 | MIRROR |

The components above make up this handrail bracket with the option of a support plate for a flat or round handrail.

Choose the stem and rail support plate to suit your application.

All components must be ordered individually.



The following tube fittings are for use with 50.8mm/2" tube.

## ADJUSTABLE RAIL SUPPORT - FLAT RAIL

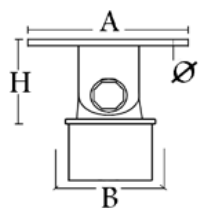

| CODE        | TUBE | WALL<br>(mm) | A<br>(mm) | B<br>(mm) | H<br>(mm) | I<br>(mm) | FINISH |
|-------------|------|--------------|-----------|-----------|-----------|-----------|--------|
| SR-SQ40112  | 2"   | 1.5mm        | 66        | 50.8      | 50        | 6         | MIRROR |
| SR-SQ40112S | 2"   | 1.5mm        | 66        | 50.8      | 50        | 6         | SATIN  |

## END CAP - FLAT

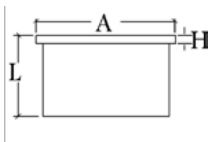

| CODE       | TUBE | WALL<br>(mm) | A<br>(mm) | H<br>(mm) | L<br>(mm) | FINISH |
|------------|------|--------------|-----------|-----------|-----------|--------|
| SR-SQ30112 | 2"   | 1.5mm        | 50.8      | 3         | 33        | MIRROR |

## FLUSH JOINER - "IN LINE"

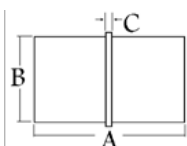

| CODE       | TUBE | WALL<br>(mm) | A<br>(mm) | B<br>(mm) | C<br>(mm) | FINISH |
|------------|------|--------------|-----------|-----------|-----------|--------|
| SR-SQ10712 | 2"   | 1.5mm        | 66        | 50.8      | 6         | MIRROR |

## FLUSH JOINER - TEE

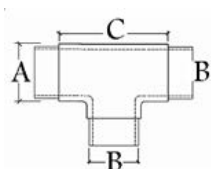

| CODE       | TUBE | WALL<br>(mm) | A<br>(mm) | B<br>(mm) | C<br>(mm) | FINISH |
|------------|------|--------------|-----------|-----------|-----------|--------|
| SR-SQ10312 | 2"   | 1.5mm        | 60        | 50.8      | 75        | MIRROR |

## FLUSH JOINER - 90DEG TEE

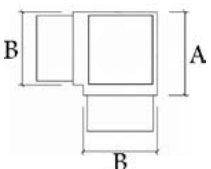

| CODE       | TUBE | WALL<br>(mm) | A<br>(mm) | B<br>(mm) | FINISH |
|------------|------|--------------|-----------|-----------|--------|
| SR-SQ10512 | 2"   | 1.5mm        | 63        | 50.8      | MIRROR |

## FLUSH JOINER - 90DEG

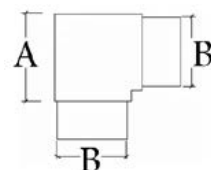

| CODE       | TUBE | WALL<br>(mm) | A<br>(mm) | B<br>(mm) | FINISH |
|------------|------|--------------|-----------|-----------|--------|
| SR-SQ10112 | 2"   | 1.5mm        | 63        | 50.8      | MIRROR |



## TUBE FITTINGS RUNOUT LINES

The components listed below will be discontinued due to low demand, once stock is depleted. These components are not featured in this catalogue but have been a part of previous publications of the 'Bridco Modular Handrail Catalogue'.

| CODE           | DESCRIPTION              | CODE           | DESCRIPTION             |
|----------------|--------------------------|----------------|-------------------------|
| AN-140303060   | ELBOW - 90 DEG - 60MM    | AN-140711048MP | RAIL SUPPORT            |
| AN-140301048   | ELBOW - 90 DEGREE        | AN-140711960   | RAIL SUPPORT            |
| AN-11801020    | ELBOW - 3 WAY ADJUSTABLE | AN-140719048MP | RAIL SUPPORT            |
| AN-11801030    | ELBOW - 3 WAY ADJUSTABLE | AN-140719060   | RAIL SUPPORT            |
| AN-140307048   | T - JOINER               | AN-140739048   | RAIL END                |
| AN-140790048   | FLUSH JOINER             | AN-145729048MP | POST CAP                |
| AN-140790048MP | FLUSH JOINER             | AN-140729060   | POST CAP                |
| AN-140790060   | FLUSH JOINER             | AN-145729048G  | POST CAP                |
| AN-10504000    | RAIL SUPPORT             | SR-ARS3WAY-50  | ADJUSTABLE RAIL SUPPORT |
| AN-10504048    | RAIL SUPPORT             | SR-EC-50/1.5   | END CAP                 |
| AN-10505000    | RAIL SUPPORT             | SR-FJT135-50   | FLUSH JOINER TEE        |
| AN-10505048    | RAIL SUPPORT             | SR-FJS4WAY-50  | FLUSH JOINER STAR       |
| AN-140726000   | RAIL SUPPORT             | SR-RSP90-50    | RAIL SUPPORT PLATE      |
| AN-140726048MP | RAIL SUPPORT             | SR-RSSF-75     | RAIL SUPPORT STEM       |
| AN-140726060   | RAIL SUPPORT             | SR-RSSS-75     | RAIL SUPPORT STEM       |

## ULTRALOC RETAINING COMPOUND

Ultraloc is a high strength performance retaining compound for slip fitted parts. Ideal for gap filling up to 0.15mm.

For application surfaces should be dry, clean & free of any contamination. Adhesive should be applied to the part in sufficient quantity to fill the gaps.

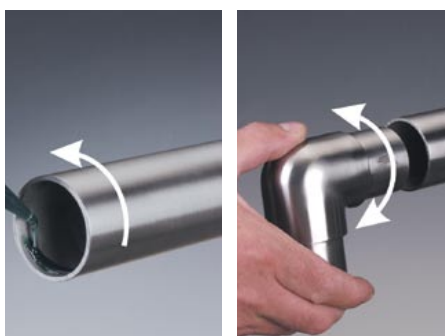

| CODE       | TUBE               | WALL (mm) |
|------------|--------------------|-----------|
| MS-3680-10 | Retaining compound | 10ml      |
| MS-3680-50 | Retaining compound | 50ml      |



DESIGN





# E X T E R I O R S

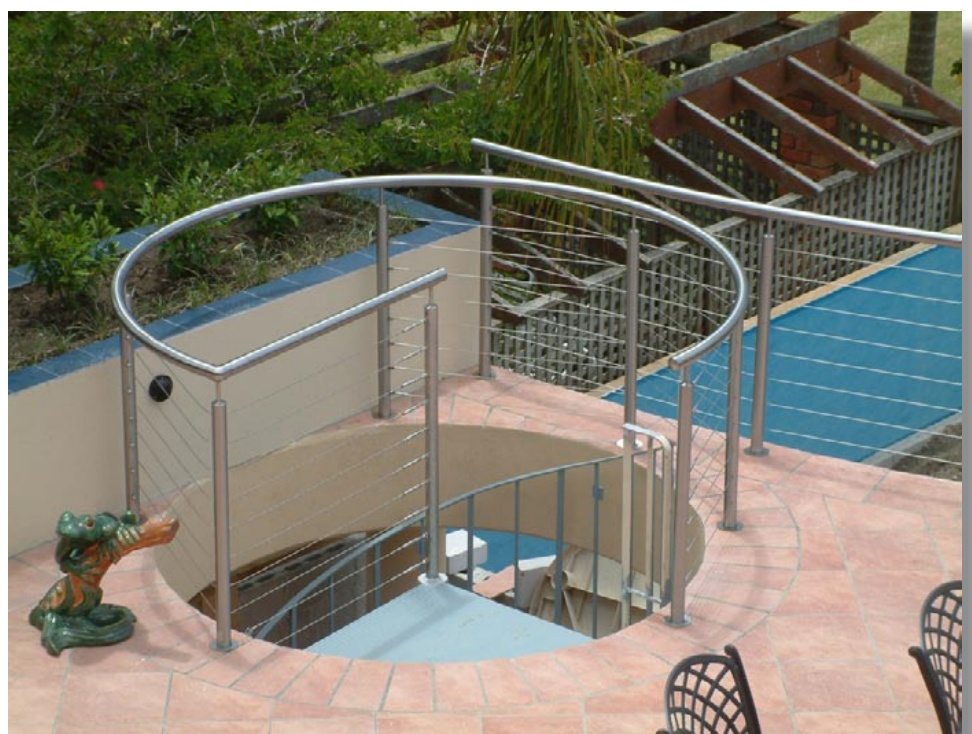



The following post fittings are for use with 48.3mm tube.

## BASE PLATE WITH RUBBER RING

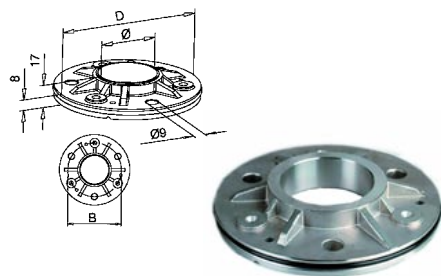

| CODE           | Ø    | B<br>(mm) | D<br>(mm) | FINISH |
|----------------|------|-----------|-----------|--------|
| AN-143502048G* | 48.3 | 90        | 115       | SATIN  |

\*DENOTES RUN OUT LINE

## BASE PLATE

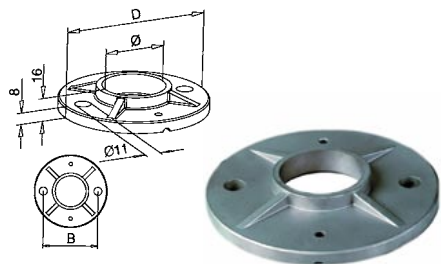

| CODE           | Ø    | B<br>(mm) | D<br>(mm) | FINISH |
|----------------|------|-----------|-----------|--------|
| AN-140940048G* | 48.3 | 75        | 100       | SATIN  |

\*DENOTES RUN OUT LINE

## BASE PLATE COVER

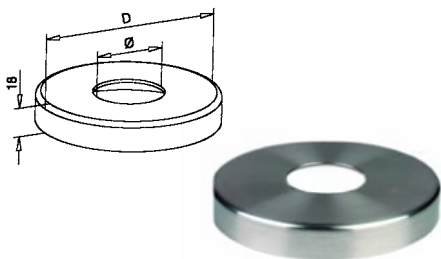

| CODE           | Ø  | D<br>(mm) | FINISH |
|----------------|----|-----------|--------|
| AN-140512048G* | 50 | 105       | SATIN  |

\*DENOTES RUN OUT LINE

## BASE PLATE COVER

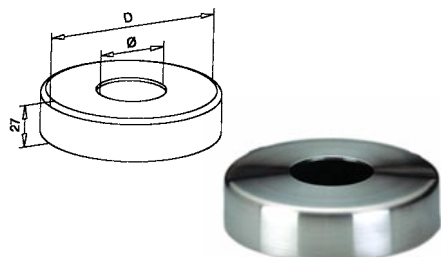

| CODE           | Ø  | D<br>(mm) | FINISH |
|----------------|----|-----------|--------|
| AN-140511048G* | 50 | 120       | SATIN  |

\*DENOTES RUN OUT LINE

## POST FLANGE

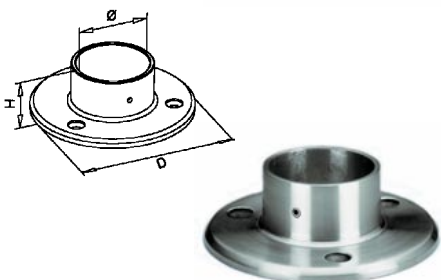

| CODE           | Ø    | D<br>(mm) | FINISH |
|----------------|------|-----------|--------|
| AN-140505048G* | 48.3 | 100       | SATIN  |

\*DENOTES RUN OUT LINE



The following post fittings are for use with 50.8mm / 2" tube.

## BASE PLATE FLANGE - ROUND BASE

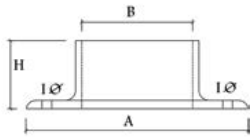

| CODE        | TUBE | A<br>(mm) | B<br>(mm) | H<br>(mm) | I<br>(mm) | FINISH |
|-------------|------|-----------|-----------|-----------|-----------|--------|
| SR-BPFR-50  | 2"   | 102       | 50.8      | 31        | 9         | MIRROR |
| SR-BPFRX-50 | 2"   | 102       | 50.8      | 31        | 9         | MIRROR |

X - Indicates flange without grub screw.

## BASE PLATE FLANGE - OBLONG BASE

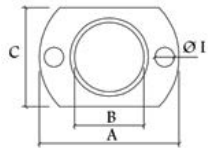

| CODE        | TUBE | A<br>(mm) | B<br>(mm) | H<br>(mm) | I<br>(mm) | C<br>(mm) | FINISH |
|-------------|------|-----------|-----------|-----------|-----------|-----------|--------|
| SR-BPF0-50  | 2"   | 100       | 50.8      | 31        | 9         | 70        | MIRROR |
| SR-BPFOX-50 | 2"   | 100       | 50.8      | 31        | 9         | 70        | MIRROR |

X - Indicates flange without grub screw.

## BASE PLATE FLANGE - OBLONG BASE - 37 DEGREE

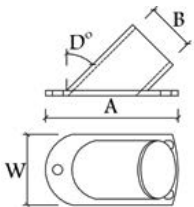

| CODE         | TUBE | D<br>(mm) | A<br>(mm) | B<br>(mm) | W<br>(mm) | I<br>(mm) | FINISH |
|--------------|------|-----------|-----------|-----------|-----------|-----------|--------|
| SR-BPF037-50 | 2"   | 37        | 110       | 50.8      | 70        | 6         | MIRROR |

## BASE PLATE - HEAVY DUTY - WELD ON

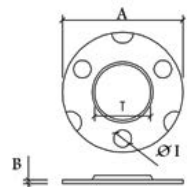

| CODE       | TUBE | A<br>(mm) | B<br>(mm) | I<br>(mm) | T<br>(mm) | FINISH |
|------------|------|-----------|-----------|-----------|-----------|--------|
| SR-BPHD-50 | 2"   | 100       | 8         | 9         | 51        | SATIN  |

## BASE PLATE / WELD ON

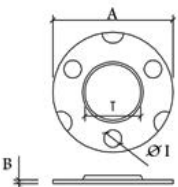

| CODE     | TUBE | A<br>(mm) | B<br>(mm) | I<br>(mm) | T<br>(mm) | FINISH |
|----------|------|-----------|-----------|-----------|-----------|--------|
| SR-BP-50 | 2"   | 100       | 3         | 8.5       | 51        | SATIN  |

## BASE PLATE COVER - ARCHED

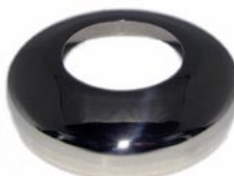
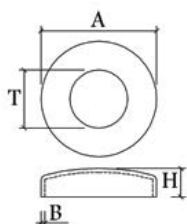

| CODE      | TUBE | A<br>(mm) | B<br>(mm) | H<br>(mm) | T<br>(mm) | FINISH |
|-----------|------|-----------|-----------|-----------|-----------|--------|
| SR-BPC-50 | 2"   | 102       | 0.8       | 26        | 51        | MIRROR |

## POST WALL BRACKET / ROUND POST

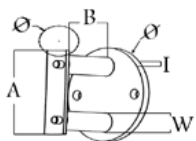

| CODE        | TUBE | A<br>(mm) | B<br>(mm) | W<br>(mm) | I<br>(mm) | FINISH |
|-------------|------|-----------|-----------|-----------|-----------|--------|
| SR-PWB-50 * | 2"   | 89.5      | 50        | 20        | 5.5       | MIRROR |

\*DENOTES RUN OUT LINE

## BASE PLATE FLANGE - SQUARE BASE

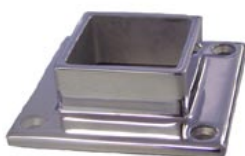
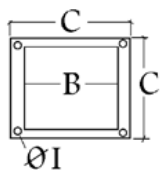

| CODE       | TUBE | WALL<br>(mm) | B<br>(mm) | C<br>(mm) | H<br>(mm) | I<br>(mm) | FINISH |
|------------|------|--------------|-----------|-----------|-----------|-----------|--------|
| SR-SQ20512 | 2"   | 1.5mm        | 50.8      | 100       | 30        | 8         | MIRROR |

## BASE PLATE FLANGE - OBLONG BASE

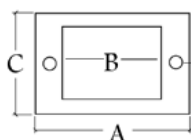

| CODE       | TUBE | WALL<br>(mm) | A<br>(mm) | B<br>(mm) | C<br>(mm) | H<br>(mm) | I<br>(mm) | FINISH |
|------------|------|--------------|-----------|-----------|-----------|-----------|-----------|--------|
| SR-SQ20112 | 2"   | 1.5mm        | 116       | 50.8      | 80        | 30        | 8         | MIRROR |

## POST FITTINGS RUNOUT LINES

The components listed below will be discontinued due to low demand, once stock is depleted. These components are not featured in this catalogue but have been a part of previous publications of the 'Bridco Modular Handrail Catalogue'.

| CODE         | DESCRIPTION         | CODE           | DESCRIPTION             |
|--------------|---------------------|----------------|-------------------------|
| AN-143510048 | HEAVY DUTY BASE     | AN-140913048MP | POST - HEAVY DUTY       |
| AN-143511048 | HEAVY DUTY BASE     | SR-BPCB-50     | BASE PLATE COVER TYPE B |
| AN-140544048 | POST - STAIR THREAD | SR-BPB-50      | BASE PLATE - TYPE B     |

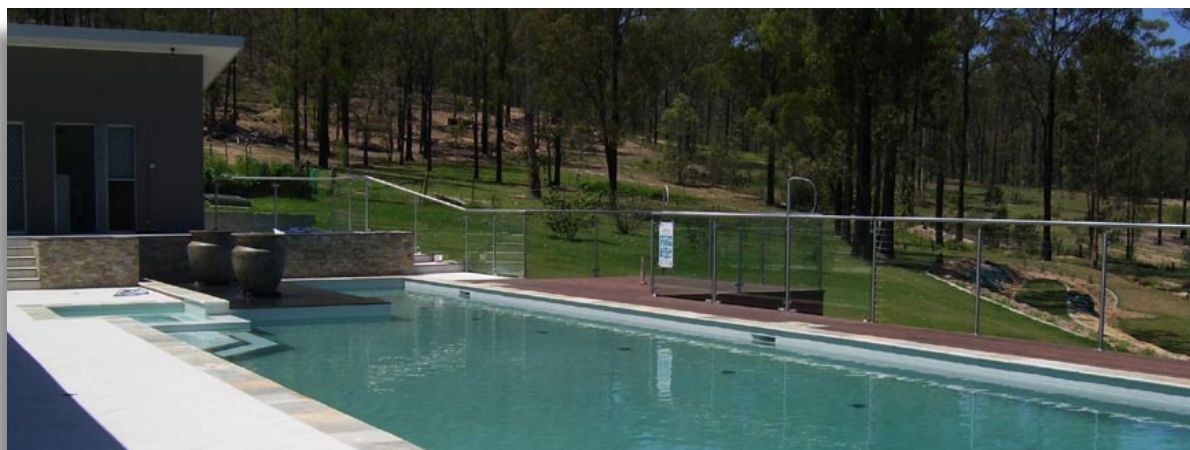





# HANDRAILS

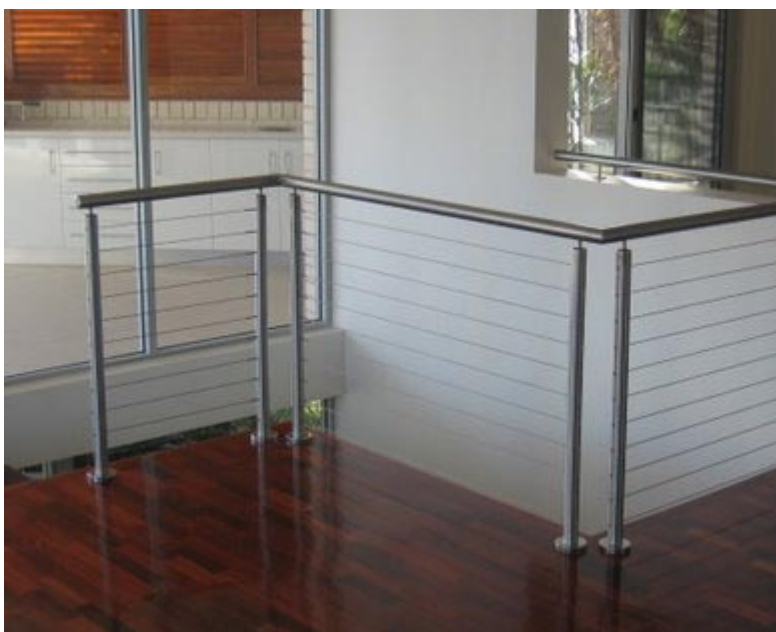

## Maintenance.

Stainless steel is not maintenance free, but maintenance friendly. When using stainless steel material outdoors you need to clean periodically, especially in aggressive environments like coastal areas or swimming pools. Washing regularly will reduce the risk of tea staining. For best results wash with soap or a mild detergent and warm water, followed by rinsing with cold water. The appearance of the surface can be improved further if the washed surface is wiped dry.

We recommend Bridco B40 cleaner and B42 polish for the best maintenance results,(see page 29).

### For high salt or commercial applications G316 with a high or mirror polish should be used.

Satin finished products require extra maintenance especially in high salt environments. Rough surface finishes promote tea staining: The smoother the surface finish, the better. A surface roughness (Ra) of less than 0.5 micrometres is strongly recommended.

Further treatments such as passivating or electrolyzing will also promote better corrosion resistance.

Please note that modular hand rail fittings, open body turnbuckles etc , in their design, also require more regular maintenance due to gaps and crevices that trap foreign contaminants.

## Stainless Steel maintenance of external applications.

Rainfall on a regular basis will remove dirt, dust and other deposits from stainless steel if the design of the facade allows. In most parts of Australia however, there is often insufficient rainfall to effectively clean external fittings, Bridco therefore recommend the use of the cleaning schedule below.

## Stainless Steel Cleaning Schedule.

| Environment                        | Distance from beachfront or sheltered bay      | Cleaning interval |
|------------------------------------|--|-------------------|
| Mild                               | 15km+  | Every 12 months   |
| Moderate                           | 1 - 15km                                       | Every 4-6 months  |
| Marine/Industrial/Urban            | 500m - beachfront / 100m - 1km - sheltered bay | Every 3 months    |
| Sever Marine/Industrial/Busy Urban | 500m - beachfront / 100m - sheltered bay       | Weekly            |

## BRIDCO USER GUIDE & CONDITIONS OF USE FOR STAINLESS STEEL COMPONENTS.

Bridco have published a four page brochure containing important information for users of stainless steel components.

The user guide covers such issues as cleaning & maintenance, stainless steel grades, corrosion resistance & environmental factors.

Bridco recommend reading this guide before purchasing or selling stainless steel fittings and/or components.

To obtain a copy of the Bridco user guide please contact our sales department, alternatively a copy can be downloaded by visiting our website: [www.bridco.com.au/links.html](http://www.bridco.com.au/links.html)

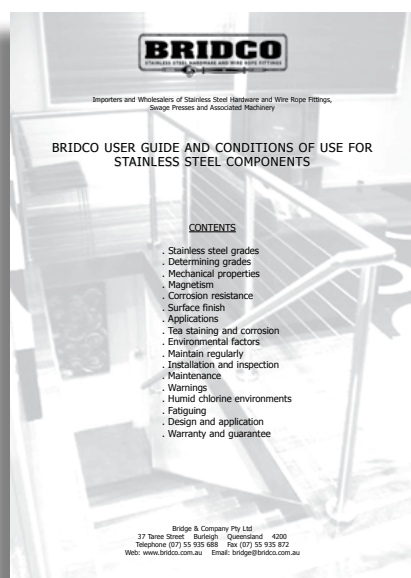



## BRIDCO CLEANER

B40 stainless steel cleaner is a mixture of acids, selected solvents and surfactants specially designed to remove tea staining and grout from stainless steel stanchions, rails, stainless steel wire rope etc. B40 will not corrode stainless steel nor will it turn green or brown as hydrochloric based cleaners will.

\*A hazardous goods surcharge of +50% is applied to all freight costs for B40.

Standard box contains 6 x 500ml spray bottles (Hazardous Cargo). 20 litre containers also available.



## BRIDCO POLISH

B42 Stainless steel cleaner is specially designed to remove tea staining and fine scratches from stainless steel railings and fittings, etc.

B42 deposits a protective low surface energy, water resistant layer which repels water and air borne contaminants for several months before re-application may be required.

Standard box contains 15 x 250ml bottles.

\*Material Data sheets are provided with B40 & B42.





## ROD HOLDER - FLAT POST - 12mm

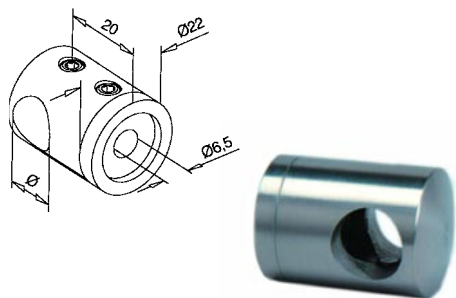

| CODE          | Ø<br>(mm) | FINISH |
|---------------|-----------|--------|
| AN-140830000G | 12        | SATIN  |

## ROD HOLDER - ROUND POST - 12mm

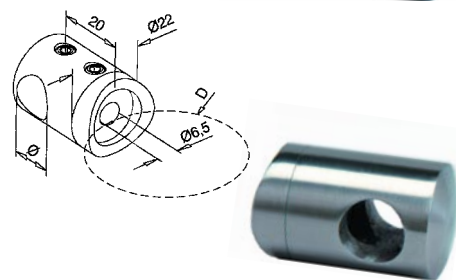

| CODE           | Ø<br>(mm) | D<br>(mm) | FINISH |
|----------------|-----------|-----------|--------|
| AN-140830048G  | 12        | 48.3-50.8 | SATIN  |
| AN-140830048MG | 12        | 48.3-50.8 | MIRROR |
| AN-140830150MG | 12.7      | 48.3-50.8 | MIRROR |

## ROD HOLDER - FLAT POST - 12mm

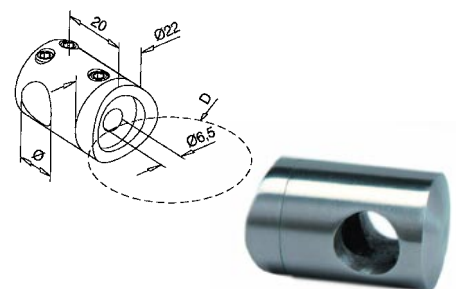

| CODE          | Ø<br>(mm) | D<br>(mm) | FINISH |
|---------------|-----------|-----------|--------|
| AN-140831048G | 12        | 48.3-50.8 | SATIN  |

## ROD HOLDER - FLAT POST - 16mm

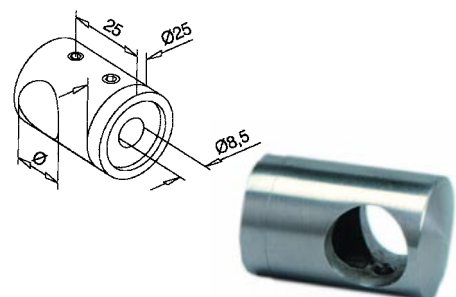

| CODE             | Ø<br>(mm) | FINISH |
|------------------|-----------|--------|
| AN-140840000MG * | 16        | MIRROR |

\* DENOTES RUN OUT ITEM

## ROD HOLDER - ROUND POST - 16mm

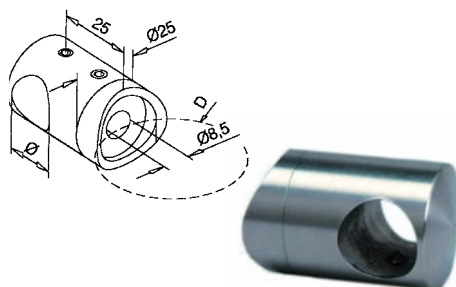

| CODE             | Ø<br>(mm) | D<br>(mm)   | FINISH |
|------------------|-----------|-------------|--------|
| AN-140840048G *  | 16        | 48.3 - 50.8 | MIRROR |
| AN-140840048MG * | 16        | 48.3 - 50.8 | MIRROR |

\* DENOTES RUN OUT ITEM

## INFORMATION

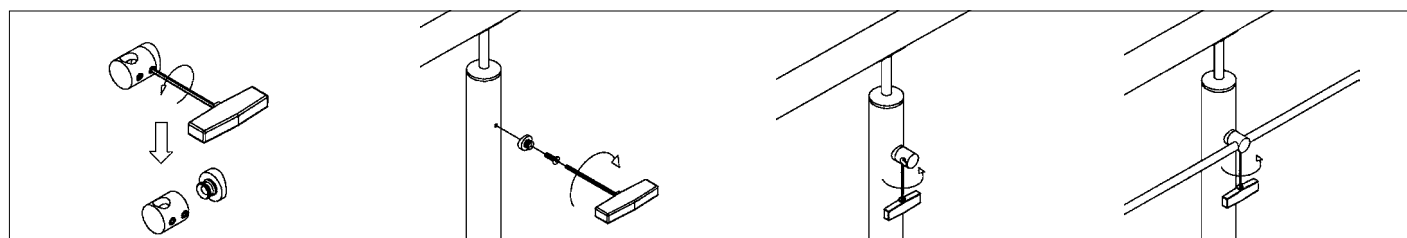

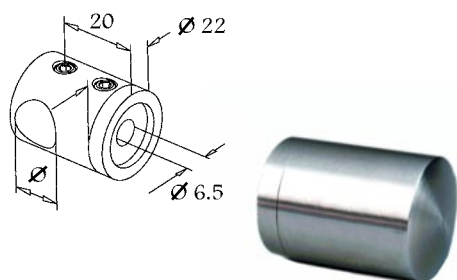

ROD HOLDER - LEFT END - FLAT POST - 12mm

| CODE           | Ø<br>(mm) | FINISH |
|----------------|-----------|--------|
| AN-140832000G* | 12        | SATIN  |

\* DENOTES RUN OUT ITEM

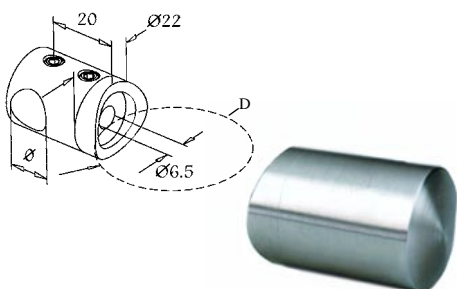

ROD HOLDER - LEFT END - ROUND POST - 12mm & 12.7mm

| CODE           | Ø    | D<br>(mm) | FINISH |
|----------------|------|-----------|--------|
| AN-140832048G  | 12   | 48.3-50.8 | SATIN  |
| AN-140832150MG | 12.7 | 48.3-50.8 | MIRROR |

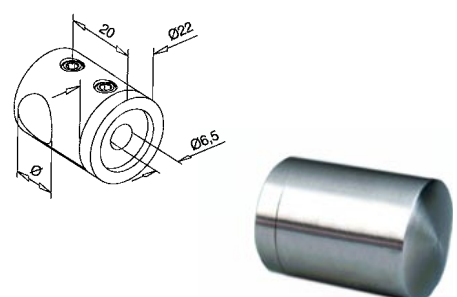

ROD HOLDER - RIGHT END - FLAT POST - 12mm

| CODE           | Ø  | FINISH |
|----------------|----|--------|
| AN-140833000G* | 12 | SATIN  |

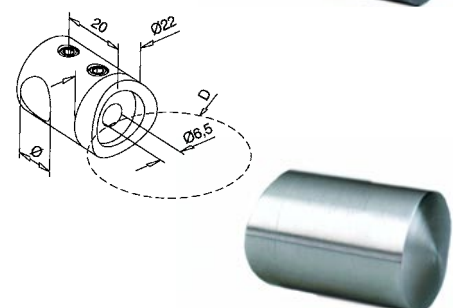

ROD HOLDER - RIGHT END - ROUND POST - 12mm - 12.7mm

| CODE           | Ø    | D<br>(mm) | FINISH |
|----------------|------|-----------|--------|
| AN-140833048G  | 12   | 48.3-50.8 | SATIN  |
| AN-140833150MG | 12.7 | 48.3-50.8 | MIRROR |



AN-140830150MG / CENTRE



AN-140833150MG / RIGHT



AN-140832150MG / LEFT

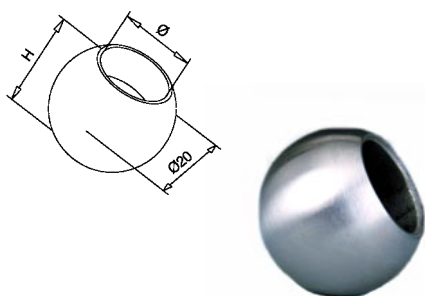

BALL END FOR 12mm ROD

| CODE         | Ø  | H        | FINISH |
|--------------|----|----------|--------|
| AN-140221012 | 12 | c.a 17.5 | SATIN  |

## ROD HOLDER RUNOUT LINES

The components listed below will be discontinued due to low demand, once stock is depleted. These components are not featured in this catalogue but have been a part of previous publications of the 'Bridco Modular Handrail Catalogue'.

| CODE         | DESCRIPTION                   | CODE         | DESCRIPTION                   |
|--------------|-------------------------------|--------------|-------------------------------|
| AN-140831000 | ROD HOLDER 12mm FOR FLAT POST | AN-140840000 | ROD HOLDER 16mm FOR FLAT POST |

## CLEANING & MAINTENANCE



BRIDCO STAINLESS STEEL CLEANER

| CODE    | DESCRIPTION                    | SIZE  |
|---------|--------------------------------|-------|
| SR-B40  | STAINLESS STEEL CLEANER        | 500ml |
| SR-B40B | STAINLESS STEEL CLEANER / BULK | 20ltr |



BRIDCO STAINLESS STEEL POLISH

| CODE   | DESCRIPTION            | SIZE  |
|--------|------------------------|-------|
| SR-B42 | STAINLESS STEEL POLISH | 250ml |







## BALUSTRADE



## GLASS CLAMP - "D" SHAPE - FLAT POST



| CODE       | T = GLASS WIDTH | FINISH |
|------------|-----------------|--------|
| AN-1420-00 | 6mm, 8mm        | SATIN  |

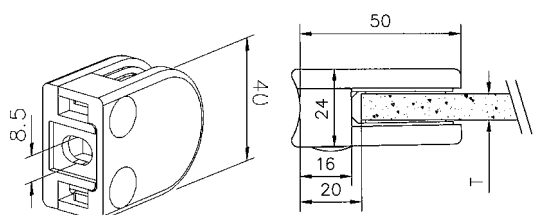

| CODE       | DESCRIPTION         | PER CLAMP |
|------------|---------------------|-----------|
| SS-SOCM820 | HEX SCREW M8 X 20mm | 1         |



## GLASS CLAMP - "D SHAPE" - FLAT POST



| CODE        | T = GLASS WIDTH | FINISH |
|-------------|-----------------|--------|
| AN-1422-00G | 6mm, 8mm, 10mm  | SATIN  |

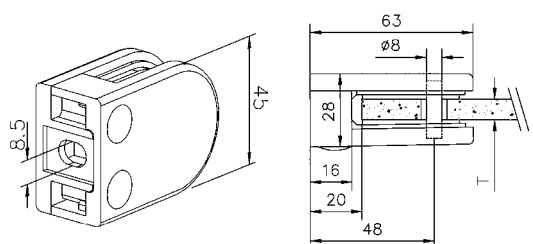

| CODE       | DESCRIPTION         | PER CLAMP |
|------------|---------------------|-----------|
| SS-SOCM820 | HEX SCREW M8 X 20mm | 1         |

| CODE         | DESCRIPTION  | PER CLAMP |
|--------------|--------------|-----------|
| AN-195015022 | SECURITY PIN | 1         |

## GLASS CLAMP - "D" SHAPE - ROUND POST



| CODE        | T = GLASS WIDTH (mm) | POST (mm)   | FINISH |
|-------------|----------------------|-------------|--------|
| AN-1422-48G | 6mm, 8mm, 10mm       | 48.3 - 50.8 | SATIN  |

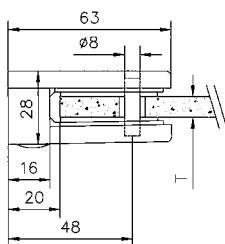
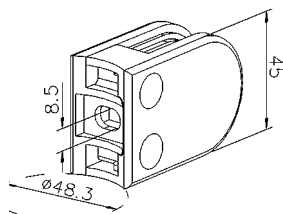

| CODE       | DESCRIPTION         | PER CLAMP |
|------------|---------------------|-----------|
| SS-SOCM820 | HEX SCREW M8 X 20mm | 1         |



| CODE         | DESCRIPTION  | PER CLAMP |
|--------------|--------------|-----------|
| AN-195015022 | SECURITY PIN | 1         |

## GLASS CLAMP - "D" SHAPE - FLAT POST



| CODE          | GLASS WIDTH | FINISH |
|---------------|-------------|--------|
| AN-1425-00G * | 12mm        | SATIN  |

\* DENOTES RUN OUT ITEM

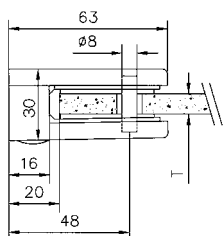
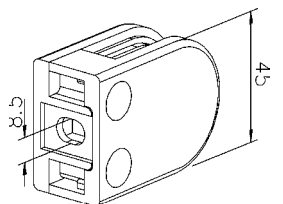

| CODE       | DESCRIPTION         | PER CLAMP |
|------------|---------------------|-----------|
| SS-SOCM820 | HEX SCREW M8 X 20mm | 1         |



| CODE         | DESCRIPTION  | PER CLAMP |
|--------------|--------------|-----------|
| AN-195015025 | SECURITY PIN | 1         |

## GLASS CLAMP - "D" SHAPE - ROUND POST



| CODE          | T = GLASS WIDTH (mm) | POST (mm)   | FINISH |
|---------------|----------------------|-------------|--------|
| AN-1425-48G * | 12mm                 | 48.3 - 50.8 | SATIN  |

\* DENOTES RUN OUT ITEM

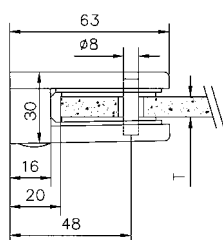
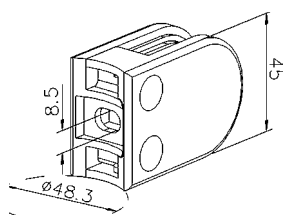

| CODE       | DESCRIPTION         | PER CLAMP |
|------------|---------------------|-----------|
| SS-SOCM820 | HEX SCREW M8 X 20mm | 1         |



| CODE         | DESCRIPTION  | PER CLAMP |
|--------------|--------------|-----------|
| AN-195015025 | SECURITY PIN | 1         |



## GLASS CLAMP - "D SHAPE" - ROUND POST



| CODE          | GLASS WIDTH | FINISH |
|---------------|-------------|--------|
| AN-1020-42G * | 6mm, 8mm    | ZINTEC |

\* DENOTES RUN OUT ITEM

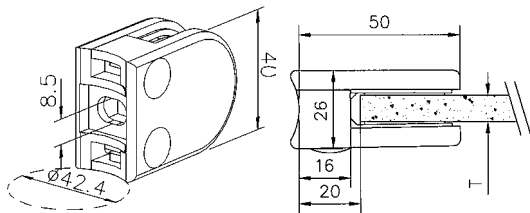

| CODE       | DESCRIPTION         | PER CLAMP |
|------------|---------------------|-----------|
| SS-SOCM820 | HEX SCREW M8 X 20mm | 1         |

## GLASS CLAMP - "D" SHAPE - ROUND POST



| CODE         | GLASS WIDTH (mm) | POST (mm)   | FINISH |
|--------------|------------------|-------------|--------|
| AN-1022-48G* | 6mm, 8mm, 10mm   | 48.3 - 50.8 | ZINTEC |

\* DENOTES RUN OUT ITEM

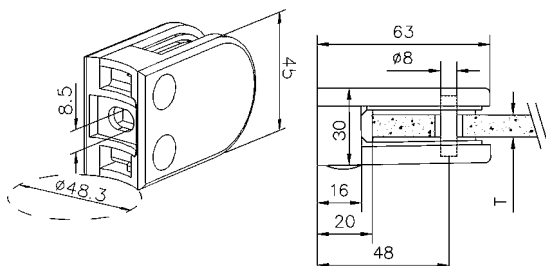

| CODE       | DESCRIPTION         | PER CLAMP |
|------------|---------------------|-----------|
| SS-SOCM820 | HEX SCREW M8 X 20mm | 1         |



| CODE         | DESCRIPTION  | PER CLAMP |
|--------------|--------------|-----------|
| AN-195015022 | SECURITY PIN | 1         |



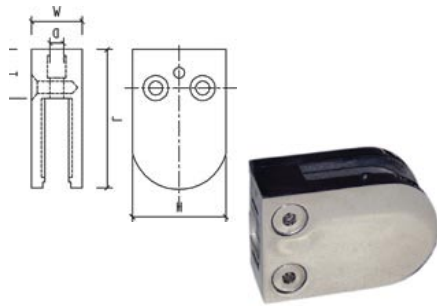

GLASS CLAMP - "D" SHAPE - FLAT POST

| CODE       | GLASS WIDTH | POST | H mm | L mm | W mm | T mm | D mm | Finish |
|------------|-------------|------|------|------|------|------|------|--------|
| SR-GCM-00  | 6, 8, 10mm  | FLAT | 45   | 63   | 26   | 16   | 9    | MP     |
| SR-GCDL-00 | 8, 10, 12mm | FLAT | 55   | 60   | 32   | 16   | 9    | MP     |



| CODE       | DESCRIPTION         | PER CLAMP |
|------------|---------------------|-----------|
| SS-SOCM820 | HEX SCREW M8 X 20mm | 1         |

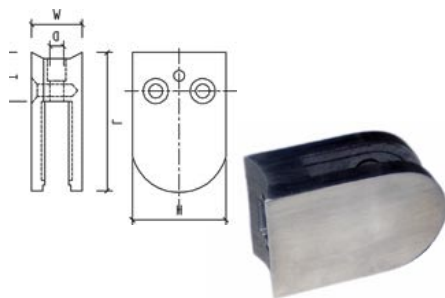

GLASS CLAMP - "D SHAPE" - ROUND POST

| CODE       | GLASS WIDTH | POST | H mm | L mm | W mm | T mm | D mm | Finish |
|------------|-------------|------|------|------|------|------|------|--------|
| SR-GCM-50  | 6, 8, 10mm  | 50.8 | 45   | 63   | 26   | 16   | 9    | MP     |
| SR-GCM-50S | 6, 8, 10mm  | 50.8 | 45   | 63   | 26   | 16   | 9    | SATIN  |
| SR-GCDL-50 | 8, 10, 12mm | 50.8 | 55   | 60   | 32   | 16   | 9    | MP     |



| CODE       | DESCRIPTION         | PER CLAMP |
|------------|---------------------|-----------|
| SS-SOCM820 | HEX SCREW M8 X 20mm | 1         |



## GLASS CLAMP - SQUARE - FLAT POST



| CODE        | T = GLASS WIDTH | FINISH |
|-------------|-----------------|--------|
| AN-1426-00G | 8mm, 10mm, 12mm | SATIN  |

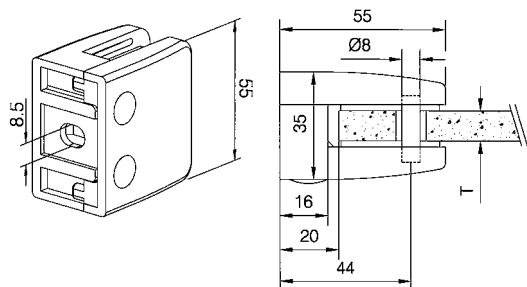

| CODE       | DESCRIPTION         | PER CLAMP |
|------------|---------------------|-----------|
| SS-SOCM820 | HEX SCREW M8 X 20mm | 1         |



| CODE         | DESCRIPTION  | PER CLAMP |
|--------------|--------------|-----------|
| AN-195015025 | SECURITY PIN | 1         |

## GLASS CLAMP - SQUARE - ROUND POST

| CODE        | T = GLASS WIDTH | FINISH |
|-------------|-----------------|--------|
| AN-1426-48G | 8mm, 10mm, 12mm | SATIN  |

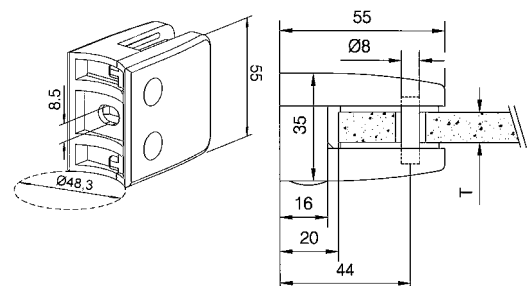

| CODE       | DESCRIPTION         | PER CLAMP |
|------------|---------------------|-----------|
| SS-SOCM820 | HEX SCREW M8 X 20mm | 1         |



| CODE         | DESCRIPTION  | PER CLAMP |
|--------------|--------------|-----------|
| AN-195015025 | SECURITY PIN | 1         |

## GLASS CLAMP - SQUARE - ROUND POST

| CODE       | T = GLASS WIDTH (mm) | POST (mm)   | FINISH |
|------------|----------------------|-------------|--------|
| AN-1424-48 | 12mm, 16mm           | 48.3 - 50.8 | SATIN  |

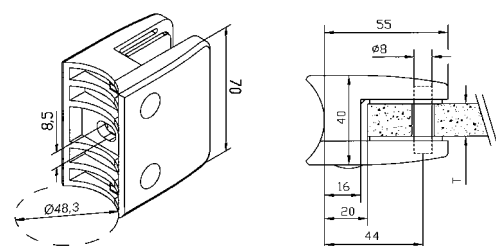

| CODE       | DESCRIPTION         | PER CLAMP |
|------------|---------------------|-----------|
| SS-SOCM820 | HEX SCREW M8 X 20mm | 1         |



| CODE         | DESCRIPTION  | PER CLAMP |
|--------------|--------------|-----------|
| AN-195015030 | SECURITY PIN | 1         |



## GLASS CLAMP - SQUARE - ROUND POST



| CODE          | T = GLASS WIDTH | FINISH |
|---------------|-----------------|--------|
| AN-1021-42G * | 6mm, 8mm, 10mm  | ZINTEC |

\* DENOTES RUN OUT ITEM

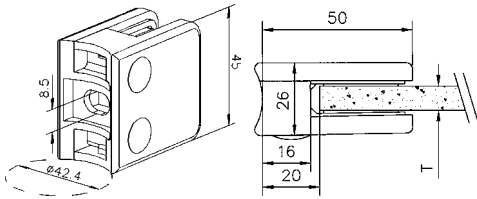

| CODE       | DESCRIPTION         | PER CLAMP |
|------------|---------------------|-----------|
| SS-SOCM820 | HEX SCREW M8 X 20mm | 1         |

## GLASS CLAMP - SQUARE - FLAT POST



| CODE          | T = GLASS WIDTH | FINISH |
|---------------|-----------------|--------|
| AN-1024-00G * | 12mm, 16mm      | ZINTEC |

\* DENOTES RUN OUT ITEM

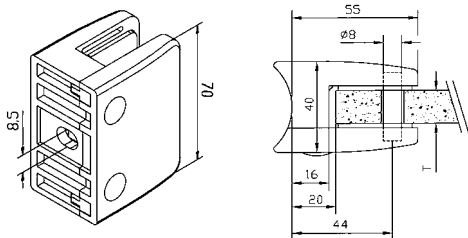

| CODE       | DESCRIPTION         | PER CLAMP |
|------------|---------------------|-----------|
| SS-SOCM820 | HEX SCREW M8 X 20mm | 1         |



| CODE         | DESCRIPTION  | PER CLAMP |
|--------------|--------------|-----------|
| AN-195015030 | SECURITY PIN | 1         |

## GLASS CLAMP - "D" SHAPE - ROUND POST



| CODE         | T = GLASS WIDTH (mm) | POST (mm)   | FINISH |
|--------------|----------------------|-------------|--------|
| AN-1024-48 * | 12mm, 16mm           | 48.3 - 50.8 | ZINTEC |

\* DENOTES RUN OUT ITEM

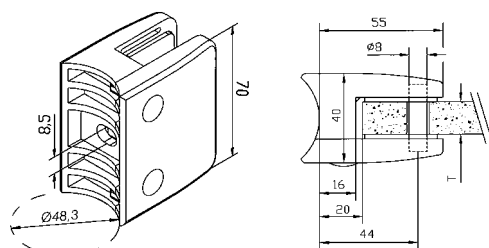

| CODE       | DESCRIPTION         | PER CLAMP |
|------------|---------------------|-----------|
| SS-SOCM820 | HEX SCREW M8 X 20mm | 1         |



| CODE         | DESCRIPTION  | PER CLAMP |
|--------------|--------------|-----------|
| AN-195015030 | SECURITY PIN | 1         |

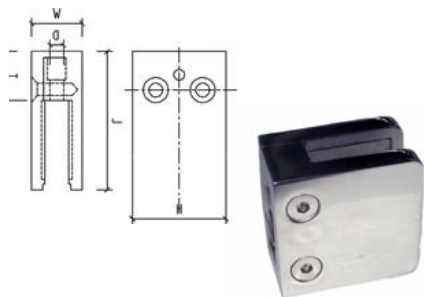

GLASS CLAMP - SQUARE - FLAT POST

| CODE         | GLASS WIDTH | POST | H mm | L mm | W mm | T mm | D | Finish |
|--------------|-------------|------|------|------|------|------|---|--------|
| SR-GCSQ-00   | 8, 10, 12mm | FLAT | 55   | 55   | 32   | 16   | 9 | MP     |
| SR-GCSQ-00S  | 8, 10, 12mm | FLAT | 55   | 55   | 32   | 16   | 9 | SATIN  |
| SR-GCSQ-00SM | 6, 8mm      | FLAT | 45   | 45   | 28   | 16   | 9 | MP     |



| CODE       | DESCRIPTION         | PER CLAMP |
|------------|---------------------|-----------|
| SS-SOCM820 | HEX SCREW M8 X 20mm | 1         |

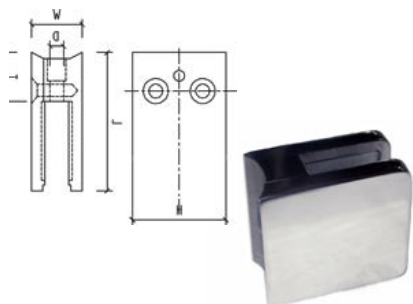

GLASS CLAMP - SQUARE - ROUND POST

| CODE         | GLASS WIDTH | POST | H mm | L mm | W mm | T mm | D mm | Finish |
|--------------|-------------|------|------|------|------|------|------|--------|
| SR-GCSQ-50   | 8, 10, 12mm | 50.8 | 55   | 55   | 32   | 16   | 9    | MP     |
| SR-GCSQ-50S  | 8, 10, 12mm | 50.8 | 55   | 55   | 32   | 16   | 9    | SATIN  |
| SR-GCSQ-50SM | 6, 8mm      | 50.8 | 45   | 45   | 28   | 16   | 9    | MP     |



| CODE       | DESCRIPTION         | PER CLAMP |
|------------|---------------------|-----------|
| SS-SOCM820 | HEX SCREW M8 X 20mm | 1         |





GLASS CLAMP - ROUND - FLAT & ROUND POST

| CODE         |           | GLASS WIDTH   | FINISH |
|--------------|-----------|---------------|--------|
| AN-1440-00   | FLAT      | 8, 10, & 12mm | SATIN  |
| AN-1440-42 * | Ø42       | 8, 10, & 12mm | SATIN  |
| AN-1440-48   | Ø48 - Ø50 | 8, 10, & 12mm | SATIN  |



| CODE       | DESCRIPTION         | PER CLAMP |
|------------|---------------------|-----------|
| SS-SOCM820 | HEX SCREW M8 X 20mm | 1         |

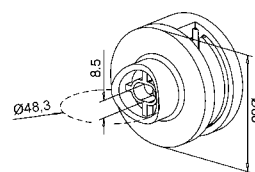
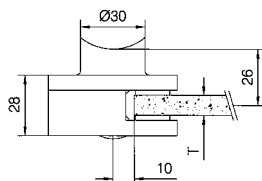
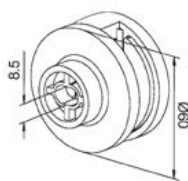

GLASS CLAMP - ROUND - FLAT & ROUND POST



| CODE         |           | GLASS WIDTH   | FINISH |
|--------------|-----------|---------------|--------|
| AN-1441-00   | FLAT      | 8, 10, & 12mm | SATIN  |
| AN-1441-42 * | Ø42       | 8, 10, & 12mm | SATIN  |
| AN-1441-48   | Ø48 - Ø50 | 8, 10, & 12mm | SATIN  |



| CODE       | DESCRIPTION         | PER CLAMP |
|------------|---------------------|-----------|
| SS-SOCM820 | HEX SCREW M8 X 20mm | 1         |

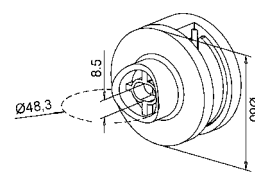
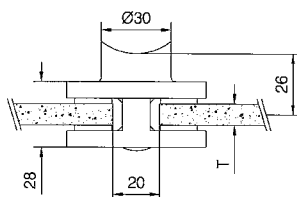
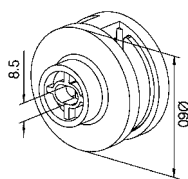



# GLASS CLAMP GASKETS

[www.bridco.com.au](http://www.bridco.com.au)



The glass clamps in this catalogue require rubber gaskets to ensure the glass can be secured safely.

The tables below are a guide to rubber gaskets, glass clamps & glass diameter.



| CODE         | FOR GLASS CLAMP           | GLASS DIA | PER CLAMP |
|--------------|---------------------------|-----------|-----------|
| AN-1420R-06  | AN-1420-00                | 6mm       | 2         |
| AN-1420R-08  | AN-1420-00                | 8mm       | 2         |
| AN-1422R-06  | AN-1422-00G / AN-1422-48G | 6mm       | 2         |
| AN-1422R-08G | AN-1422-00G / AN-1422-48G | 8mm       | 2         |
| AN-1422R-10G | AN-1422-00G / AN-1422-48G | 10mm      | 2         |
| AN-1425R-12G | AN-1425-00G / AN-1425-48G | 12mm      | 2         |



| CODE         | FOR GLASS CLAMP           | GLASS DIA | PER CLAMP |
|--------------|---------------------------|-----------|-----------|
| AN-1426R-08  | AN-1426-00G / AN-1426-48G | 8mm       | 2         |
| AN-1426R-10G | AN-1426-00G / AN-1426-48G | 10mm      | 2         |
| AN-1426R-12G | AN-1426-00G / AN-1426-48G | 12mm      | 2         |
| AN-1424R-16  | AN-1424-48                | 16mm      | 2         |



| CODE         | FOR GLASS CLAMP                        | GLASS DIA | PER CLAMP |
|--------------|--|-----------|-----------|
| AN-1440R-08  | AN-1440-00/42/48<br>AN-1441-00G/42/48G | 8mm       | 2<br>4    |
| AN-1440R-10  | AN-1440-00/42/48<br>AN-1441-00G/42/48G | 10mm      | 2<br>4    |
| AN-1440R-12G | AN-1440-00/42/48<br>AN-1441-00G/42/48G | 12mm      | 2<br>4    |



| CODE         | FOR GLASS CLAMP       | GLASS DIA | PER CLAMP |
|--------------|-----------------------|-----------|-----------|
| SR-GCSQR-08  | SR-GCSQ-00/50/00S/50S | 8mm       | 2         |
| SR-GCSQR-10  | SR-GCSQ-00/50/00S/50S | 10mm      | 2         |
| SR-GCSQR-12  | SR-GCSQ-00/50/00S/50S | 12mm      | 2         |
| SR-GCSQRS-06 | SR-GCSQ-00SM/50SM     | 6mm       | 2         |
| SR-GCSQR-08  | SR-GCSQ-00SM/50SM     | 8mm       | 2         |



| CODE       | FOR GLASS CLAMP  | GLASS DIA | PER CLAMP |
|------------|------------------|-----------|-----------|
| SR-GCMR-06 | SR-GCM-00/50/50S | 6mm       | 2         |
| SR-GCMR-08 | SR-GCM-00/50/50S | 8mm       | 2         |
| SR-GCMR-10 | SR-GCM-00/50/50S | 10mm      | 2         |
| SR-GCMR-12 | SR-GCDL-00/50    | 12mm      | 2         |

## GLASS CLAMP RUNOUT LINES

The components listed below will be discontinued due to low demand, once stock is depleted. These components are not featured in this catalogue but have been a part of previous publications of the 'Bridco Modular Handrail Catalogue'.

| CODE         | DESCRIPTION                     | CODE         | DESCRIPTION                 |
|--------------|---------------------------------|--------------|-----------------------------|
| AN-1421-00G  | SQUARE GLASS CLAMP / FLAT POST  | AN-1427-00   | "D" SHAPED MINI GLASS CLAMP |
| AN-1421-42   | SQUARE GLASS CLAMP / ROUND POST | AN-1427R-06  | 6mm GASKET                  |
| AN-1421R-06  | 6mm GASKET                      | AN-1427R-08  | 8mm GASKET                  |
| AN-1421R-08  | 8mm GASKET                      | AN-1424R-12  | 12mm GASKET                 |
| AN-1421R-10  | 10mm GASKET                     | AN-1422R-08Z | 8mm GASKET                  |
| AN-1026-00G  | ZINTEC SQUARE CLAMP / FLAT POST | AN-1424R-12  | 12mm GASKET                 |
| AN-1426R-08  | 8mm GASKET                      | AN-1426R-12G | 12mm GASKET                 |
| AN-1426R-10G | 10mm GASKET                     |              |                             |

## POOL GATE ACCESSORIES

As a part of our Modular Handrail Systems range, Bridco have stainless steel pool gate hinges and locks.

### POOL GATE HINGES

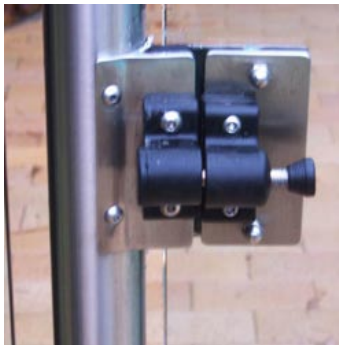

| CODE        | DESCRIPTION                                      |
|-------------|--|
| SS-HINGE    | STAINLESS STEEL GATE HINGE (pair)                |
| SS-HINGE/SQ | STAINLESS STEEL HINGE TO SUIT SQUARE POST (pair) |

### POOL GATE LOCKS



| CODE            | DESCRIPTION  |
|-----------------|--|
| SS-LOCK         | POOL GATE LOCK                                     |
| SS-PGL 180      | POOL GATE LOCK / GLASS FRICTION (slim line)        |
| SS-PGL CORNER   | POOL GATE LOCK / 90 deg CORNER LATCH ( slim line)  |
| SS-PGL ROUND    | POOL GATE LOCK TO SUIT 50mm ROUND POST (slim line) |
| SS-PGL - SQUARE | POOL GATE LOCK TO SUIT SQUARE POST (slim line)     |

## GLASS ADAPTER - FLAT SURFACES

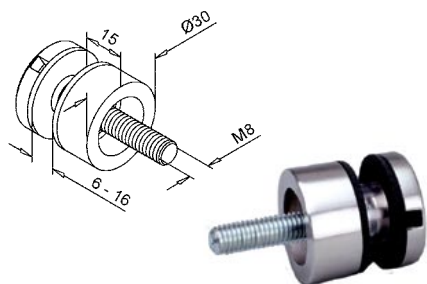

| CODE          | SURFACE | FINISH |
|---------------|---------|--------|
| AN-140746000G | FLAT    | SATIN  |

## GLASS ADAPTER - ROUND SURFACES

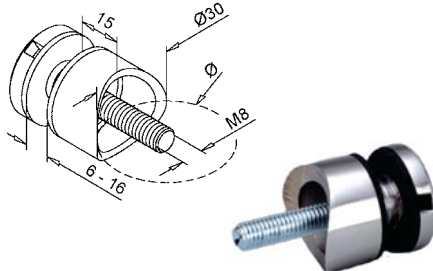

| CODE          | SURFACE   | FINISH |
|---------------|-----------|--------|
| AN-140746048G | 48mm TUBE | SATIN  |

## GLASS ADAPTER - FLAT SURFACES

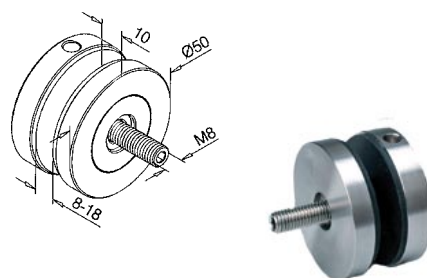

| CODE          | SURFACE | FINISH |
|---------------|---------|--------|
| AN-140747000G | FLAT    | SATIN  |

## GLASS ADAPTER - ROUND SURFACES

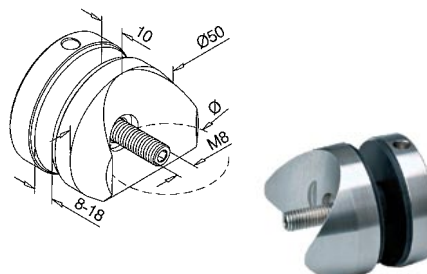

| CODE          | SURFACE   | FINISH |
|---------------|-----------|--------|
| AN-140747048G | 48mm TUBE | SATIN  |

## SHEET CLAMP FOR FLAT POST

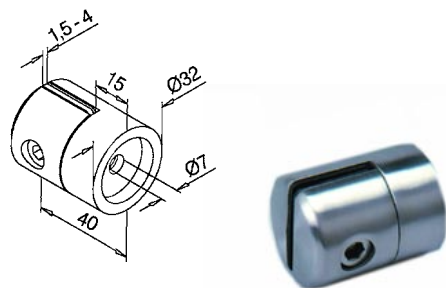

| CODE         | DESCRIPTION   | FINISH |
|--------------|---------------|--------|
| AN-140744000 | SIGNAGE CLAMP | SATIN  |

## SHEET CLAMP FOR ROUND POST

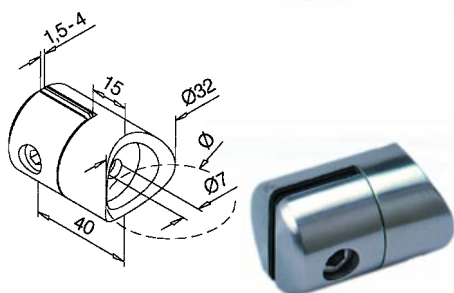

| CODE         | DESCRIPTION   | FINISH |
|--------------|---------------|--------|
| AN-140744048 | SIGNAGE CLAMP | SATIN  |



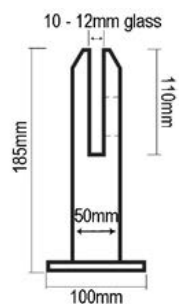

STAINLESS STEEL SPIGOT - BASE PLATE MOUNT

| CODE         | GLASS DIAMETER | FINISH        |
|--------------|----------------|---------------|
| SR-SPIGBP-50 | 10-12mm        | MIRROR POLISH |

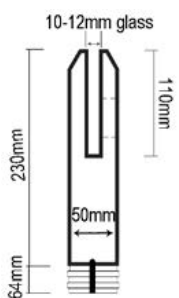

STAINLESS STEEL SPIGOT - CORE DRILL MOUNT

| CODE         | GLASS DIAMETER | FINISH        |
|--------------|----------------|---------------|
| SR-SPIGCD-50 | 10-12mm        | MIRROR POLISH |

Drilling of glass is not required for the above spigots.

## GLASS FENCING



## ELBOW - 90 DEGREE

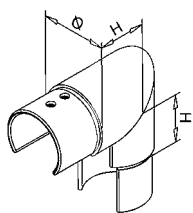

| CODE          | Ø              | H  | FINISH |
|---------------|----------------|----|--------|
| AN-146303048G | 48.3mm x 1.5mm | 35 | SATIN  |

## CORNER - 90 DEGREE

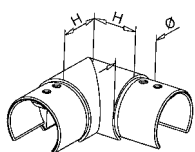

| CODE           | Ø              | H  | FINISH |
|----------------|----------------|----|--------|
| AN-146313048G  | 48.3mm x 1.5mm | 35 | SATIN  |
| AN-146313048MG | 48.3mm x 1.5mm | 35 | MIRROR |

## CONNECTOR

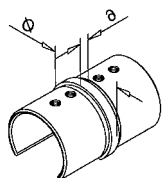

| CODE          | Ø              | FINISH |
|---------------|----------------|--------|
| AN-146790048G | 48.3mm x 1.5mm | SATIN  |

## ENDCAP

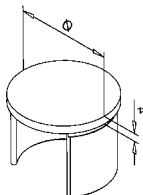

| CODE          | Ø              | FINISH |
|---------------|----------------|--------|
| AN-146732048G | 48.3mm x 1.5mm | SATIN  |

## UNIVERSAL FITTING

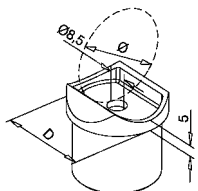

| CODE           | D              | Ø    | FINISH |
|----------------|----------------|------|--------|
| AN-146726048G  | 48.3mm x 1.5mm | 48.3 | SATIN  |
| AN-146726048MG | 48.3mm x 1.5mm | 48.3 | MIRROR |



## GLASS ADAPTER / FLAT SURFACES

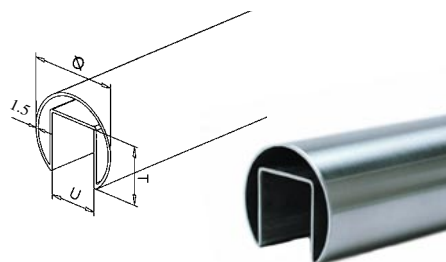

| CODE           | U  | T  | LENGTH | FINISH |
|----------------|----|----|--------|--------|
| AN-146920048G  | 27 | 30 | 5000mm | SATIN  |
| AN-146920048MG | 27 | 30 | 5000mm | MIRROR |

## GLASS ADAPTER - ROUND SURFACES

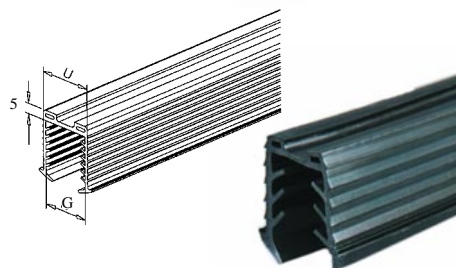

| CODE          | U  | G             |
|---------------|----|---------------|
| AN-195048008  | 27 | 8-11mm        |
| AN-195048011G | 27 | 11.5 - 13.5mm |
| AN-195048016G | 27 | 16 - 17.5mm   |

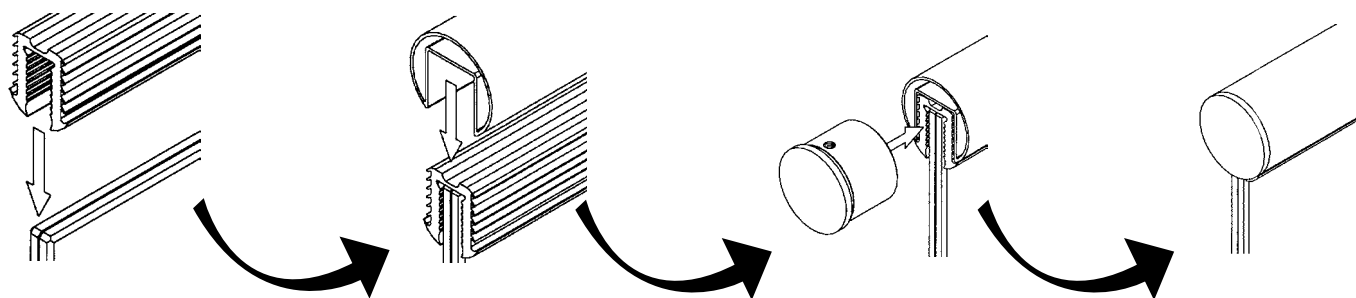



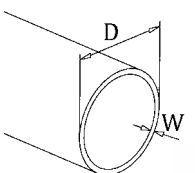
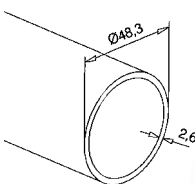
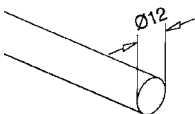

## STAINLESS STEEL ROD

| CODE           | DIAMETER | FINISH |
|----------------|----------|--------|
| AN-1409000120G | 5000mm   | SATIN  |

## STAINLESS STEEL TUBE

| CODE          | DIAMETER | FINISH |
|---------------|----------|--------|
| AN-140900048G | 5000mm   | SATIN  |

## STAINLESS STEEL TUBE

| CODE       | DESCRIPTION        | WALL<br>mm | L      | DIAMETER<br>mm |
|------------|--------------------|------------|--------|----------------|
| SR-TUBE    | 2" M/POLISH TUBE   | 1.55       | 6000mm | 50.8           |
| SR-TUBEHD  | 2" M/POLISH TUBE   | 2          | 6000mm | 50.8           |
| SR-TUBE-25 | 1" M/POLISH TUBE   | 1.5        | 6000mm | 25             |
| SR-TUBE-12 | 1/2" M/POLISH TUBE | 1.2        | 6000mm | 12.7           |

SR-TUBE = INTERMEDIATE POSTS

SR-TUBEHD = SUPPORT POSTS

## STAINLESS STEEL TUBE - SQUARE

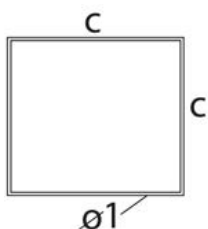

| CODE      | DESCRIPTION        | I Ø | L      | C    |
|-----------|--------------------|-----|--------|------|
| SR-SQTUBE | 2" M/POLISH SQTUBE | 1.6 | 6000mm | 50.8 |

Stainless steel tube is available in both 5000mm & 6000mm lengths. Please ensure the correct length is available prior to ordering.

## ROD & TUBE RUNOUT LINES

The components listed below will be discontinued due to low demand, once stock is depleted. These components are not featured in this catalogue.

| CODE         | DESCRIPTION  | CODE          | DESCRIPTION                 |
|--------------|--------------|---------------|-----------------------------|
| AN-140903048 | 90 DEG BEND  | AN-1409000120 | 33.7mm STAINLESS STEEL TUBE |
| AN-140906048 | 180 DEG BEND | AN-140900233  | 60mm STAINLESS STEEL TUBE   |

## DISPLAY UNITS



Bridco can design and assemble counter display and floor display units to suit your individual needs. Small units can be assembled prior to delivery and larger units partially assembled to allow for packaging and delivery. Final assembly would be required once unit was delivered.

## EXHIBITION PARTITIONS

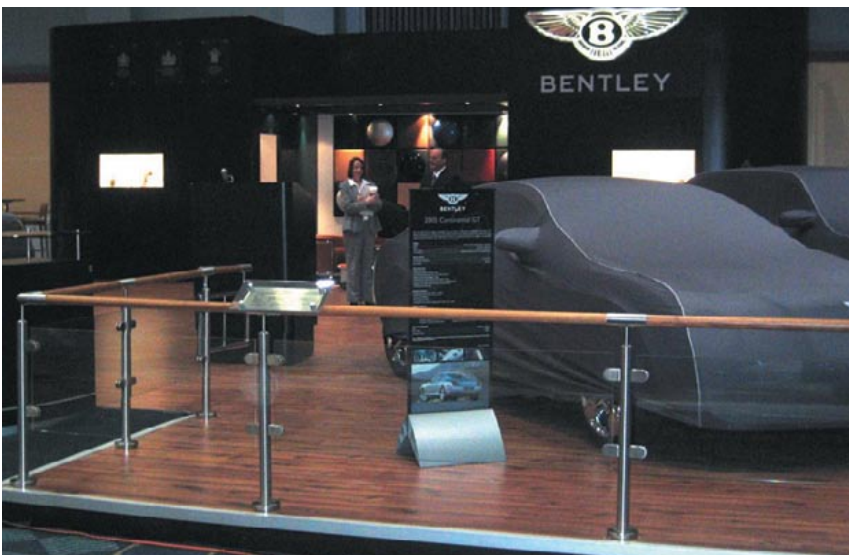

Bridco stainless steel modular handrails are perfect when a barrier is needed for your exhibition show case.

Our staff can pre-cut and assemble your railing partitions to suit your individual show case requirements.

Your partition can be couriered to the venue of your choice ready for installation.

Our experienced staff will be happy to assist you with your partition needs.

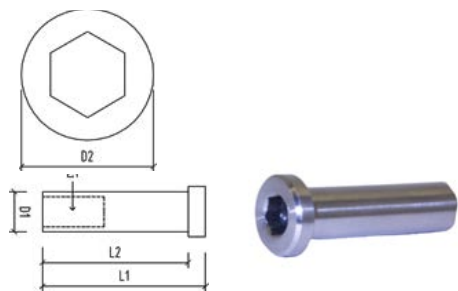

TENSIONER - ALLEN KEY HEAD AISI 316

| CODE       | D1 | D2 | L1 | L2 | G  |
|------------|----|----|----|----|----|
| SS-7500-05 | 8  | 12 | 33 | 30 | M5 |
| SS-7500-06 | 8  | 12 | 40 | 35 | M6 |

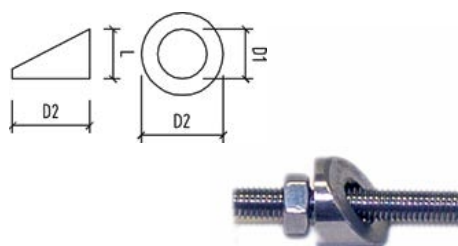

STAINLESS STEEL BEVELLED WASHER AISI 316

| CODE       | D1 | D2 | ANGLE | L  |
|------------|----|----|-------|----|
| SS-7702-01 | 6  | 13 | 35deg | 11 |
| SS-7702-02 | 8  | 13 | 35deg | 11 |

Above item to be used with a bevelled washer for angles.

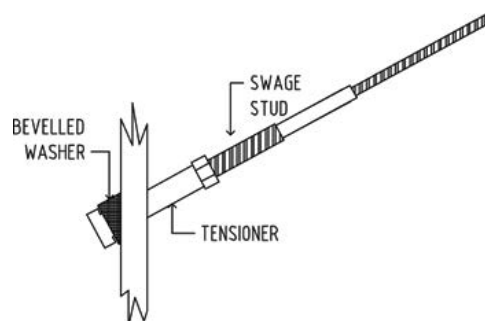
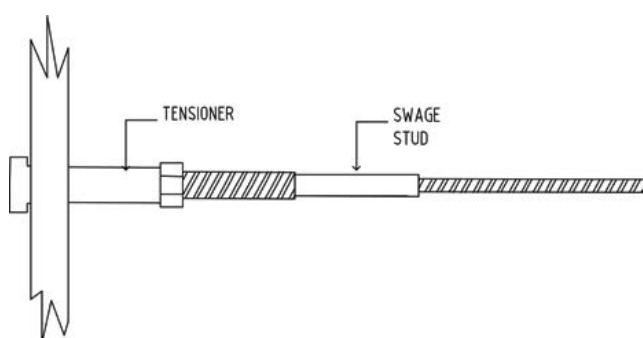

For use on stairways where a through post fitting such as a tensioner or terminal is being used. SS-7702-02 can be used with BRIDCO tensioner SS-7500.

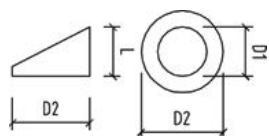

NYLON WASHER TO SUIT TENSIONERS

| CODE          | TO SUIT                 |
|---------------|-------------------------|
| NR-WASH-08NYL | SS-7500-05 / SS-7500-06 |

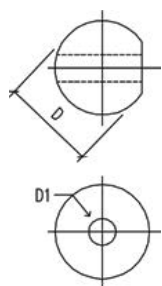

ARCHITECTURAL BALL AISI 316

| CODE        | D  | D1  | D2 |
|-------------|----|-----|----|
| SS-7701-503 | 15 | 5.3 | 10 |
| SS-7701-604 | 20 | 6.3 | 11 |





# STAINLESS STEEL FITTINGS

Telephone (07) 55 93 56 88

## PULLEYS FOR CONTINUOUS CABLES - FLAT RAIL

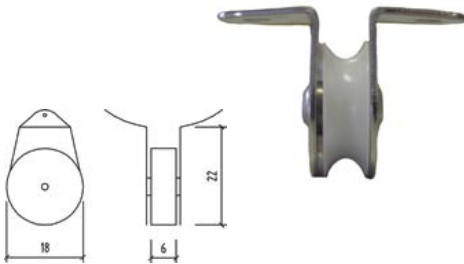

| CODE       | SHEAVE | DESCRIPTION           |
|------------|--------|-----------------------|
| SR-8240-00 | NYLON  | TO SUIT FLAT SURFACES |

## PULLEYS FOR CONTINUOUS CABLES - ROUND RAIL



| CODE       | SHEAVE | DESCRIPTION                    |
|------------|--------|--------------------------------|
| SR-8240-50 | NYLON  | TO SUIT ROUND SURFACE 50mm DIA |

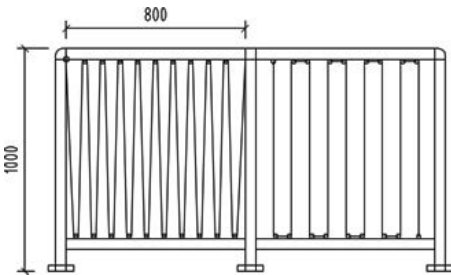

Post Distance 800mm Max  
Height 1000mm Max  
Pulley Centre 80mm Max  
Tension Required 32.2kg Min  
Wire Size 2.5mm  
Wire Construction 7x7 or 7x19



## FORK TERMINAL AISI 316

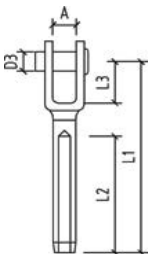

| CODE          | WIRE DIA<br>MET | WIRE DIA<br>IMP | D3 | L1 | L2 | L3   | A  |
|---------------|-----------------|-----------------|----|----|----|------|----|
| *SS-7803X-025 | 2.5             | 3/32"           | 5  | 45 | 28 | 11.5 | 7  |
| *SS-7803-225  | 2.5             | 3/32"           | 5  | 60 | 45 | 11.5 | 7  |
| *SS-7803-905  |                 | 1/8"            | 5  | 45 | 28 | 11.5 | 7  |
| SS-7803-305   |                 | 1/8"            | 5  | 67 | 40 | 11.5 | 7  |
| SS-7801M-305  | 3               |                 | 5  | 67 | 40 | 12   | 7  |
| SS-7803-03    |                 | 1/8"            | 6  | 65 | 32 | 13   | 8  |
| SS-7803M-03   | 3               |                 | 6  | 65 | 32 | 13   | 8  |
| SS-7803-406   | 4               | 5/32"           | 6  | 73 | 45 | 15   | 8  |
| SS-7803-04    | 4               | 5/32"           | 8  | 77 | 46 | 15   | 11 |
| SS-7803-05    |                 | 3/16"           | 9  | 87 | 51 | 18   | 11 |

## INTERNAL THREAD TERMINAL AISI 316

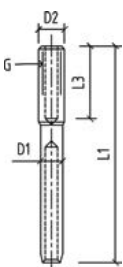

| CODE        | WIRE DIA | L1 | D1   | D2 | L3 | G  |
|-------------|----------|----|------|----|----|----|
| SS-7811-503 | 1/8"     | 88 | 6.35 | 8  | 35 | M5 |
| SS-7811-604 | 5/32"    | 95 | 7.5  | 8  | 35 | M6 |

## FLAT HEAD TERMINAL AISI 316



| CODE        | WIRE DIA | A1   | A2 | L1   |
|-------------|----------|------|----|------|
| SS-7840-03Z | 1/8"     | 6.35 | 10 | 48.5 |
| SS-7840-04  | 5/32"    | 7.5  | 12 | 59   |

## CONE HEAD TERMINALS AISI 304

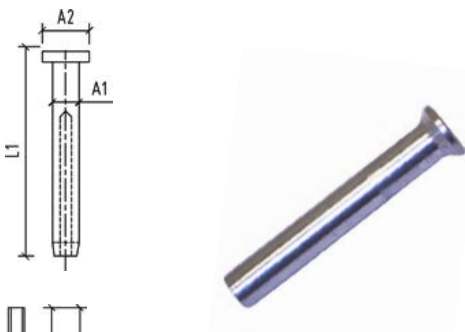

| CODE       | WIRE DIA | A1  | A2 | L1   |
|------------|----------|-----|----|------|
| SS-7841-03 | 1/8"     | 6.3 | 10 | 48.5 |

## SWAGE STUDS - THREADED TERMINAL AISI 316



| CODE          | WIRE DIA<br>MET | WIRE DIA<br>IMP | THREAD  | L1   | L2 | L3<br>THREAD |
|---------------|-----------------|-----------------|---------|------|----|--------------|
| SS-7801-03L   |                 | 1/8"            | M6 LEFT | 91   | 40 | 40           |
| SS-7801-03M   |                 | 1/8"            | M6      | 91   | 40 | 40           |
| SS-7801M-03M  | 3               |                 | M6      | 97   | 40 | 48           |
| SS-7801M-03ML | 3               |                 | M6LONG  | 118  | 40 | 75           |
| SS-7801-03ML  |                 | 1/8"            | M6LONG  | 118  | 40 | 75           |
| SS-7801-03MY  |                 | 1/8"            | M6      | 100  | 52 | 42           |
| SS-7801-305   |                 | 1/8"            | M5      | 91   | 40 | 40           |
| SS-7801-020   |                 | 1/8"            | M5      | 59   | 33 | 22.5         |
| SS-7801M-020  | 3               |                 | M5      | 58.7 | 34 | 22.5         |
| SS-7801M-305M | 3               |                 | M5      | 91   | 40 | 40           |
| SS-7801-305L  |                 | 1/8"            | M5LEFT  | 90   | 40 | 40           |
| SS-7801-04L   | 4               | 5/32"           | M8LEFT  | 118  | 43 | 57           |
| SS-7801-04M   | 4               | 5/32"           | M8      | 120  | 47 | 60           |
| SS-7801-04ML  | 4               | 5/32"           | M8LONG  | 143  | 47 | 90           |
| SS-7801-046   | 4               | 5/32"           | M6      | 116  | 46 | 50           |
| SS-7801-046L  | 4               | 5/32"           | M6LEFT  | 116  | 46 | 50           |
| SS-7801-05L   |                 | 3/16"           | M8LEFT  | 121  | 58 | 57           |
| SS-7801-05M   |                 | 3/16"           | M8      | 121  | 53 | 60           |
| SS-7801-510   |                 | 3/16"           | M10     | 129  | 56 | 60           |
| SS-7801-05ML  |                 | 3/16"           | M10LONG | 177  | 58 | 115          |
| SS-7801-06M   |                 | 1/4"            | M12     | 181  | 67 | 105          |
| SS-7801M-06M  | 6               |                 | M12     | 162  | 67 | 78           |
| SS-7801M-06ML | 6               |                 | M12LONG | 222  | 67 | 143          |

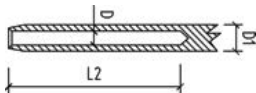

| WIRE<br>SIZE | D<br>+0.2 | D1<br>+0.05 | D1<br>AFTER<br>SWAGING |
|--------------|-----------|-------------|------------------------|
| 3/32"        | 2.8       | 5.5         | 4.7 - 4.82             |
| 1/8"         | 3.5       | 6.35        | 5.44 - 5.56            |
| 5/32"        | 4.4       | 7.5         | 6.23 - 6.35            |
| 3/16"        | 5.1       | 9.          | 7.83 - 7.95            |
| 7/32"        | 5.8       | 10.8        | 9.35 - 9.50            |
| M6           | 6.5       | 12.5        | 10.95 - 11.12          |
| 1/4"         | 6.8       | 12.5        | 10.95 - 11.12          |
| 5/16"        | 8.4       | 16          | 14.07 - 14.3           |
| 3/8"         | 10        | 17.8        | 15.7 - 15.9            |
| M10          | 10.5      | 17.8        | 15.7 - 15.9            |
| M12          | 12.5      | 21.4        | 18.82 - 19.05          |
| 1/2"         | 13.5      | 21.4        | 18.82 - 19.05          |
| M14          | 14.8      | 25          | 22.00 - 23.23          |
| 5/8"         |           | 28          | 25.15 - 25.40          |

# STAINLESS STEEL FITTINGS

Telephone (07) 55 93 56 88

## BUTTON HEAD SOCKET SCREW



| CODE     | HEAD DIA | LENGTH | THREAD |
|----------|----------|--------|--------|
| SS-98-05 | 9        | 30     | M5     |
| SS-98-06 | 10       | 40     | M6     |

## HAMMER PINS AISI 316



| CODE     | SIZE | LENGTH | TO SUIT                    |
|----------|------|--------|----------------------------|
| SS-HP-05 | M5   | 11     | SS-7803-305<br>SS-312T-503 |
| SS-HP-06 | M6   | 13     | SS-7803-03<br>SS-312T-604  |

## BOTTLESCREWS - JAW & SWAGE STUD AISI 316

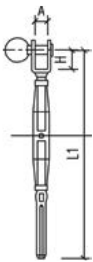

| CODE          | THREAD SIZE | TO SUIT WIRE | L1 MIN | L1 MAX | H    | A | PIN DIA | TDL KG |
|---------------|-------------|--------------|--------|--------|------|---|---------|--------|
| *SS-312TX-025 | M5          | 3/32"        | 109    | 149    | 11.5 | 6 | 5       | 600    |
| *SS-312T-020  | M5          | 1/8"         | 109    | 149    | 11.5 | 6 | 5       | 600    |
| SS-312T-503   | M5          | 1/8"         | 153    | 193    | 11.5 | 6 | 5       | 600    |
| SS-312T-604   | M6          | 5/32"        | 177    | 225    | 12.5 | 8 | 6       | 1000   |
| SS-312T-635   | M6          | 1/8"         | 167    | 207    | 12.5 | 8 | 6       | 1000   |

\* Indicates mini fittings. Both mini bottlescrews are pressed with HEX 3 dies.



## BOTTLESCREW - TOGGLE & SWAGE STUD

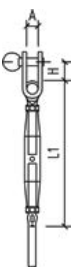

| CODE        | THREAD SIZE | TO SUIT WIRE | L1 MIN | L1 MAX | H    | A    | PIN DIA | TDL KG |
|-------------|-------------|--------------|--------|--------|------|------|---------|--------|
| SS-3121T-63 | M6          | 1/8"         | 142    | 215    | 12   | 8    | 6       | 940    |
| SS-3121T-64 | M6          | 5/32"        | 142    | 215    | 12   | 8    | 6       | 940    |
| SS-3121T-84 | M8          | 5/32"        | 180    | 260    | 12.5 | 11.5 | 8       | 1800   |



# STAINLESS STEEL FITTINGS

[www.bridco.com.au](http://www.bridco.com.au)

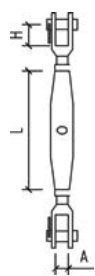

BOTTLESCREW - JAW & JAW WITH LOCK NUTS AISI 316

| CODE       | DIA | LENGTH |     | A    | H    | L   | TDL<br>KG |
|------------|-----|--------|-----|------|------|-----|-----------|
|            |     | MIN    | MAX |      |      |     |           |
| SS-312J-05 | M5  | 125    | 185 | 7.5  | 11.5 | 80  | 750       |
| SS-312J-06 | M6  | 140    | 215 | 8.3  | 12.5 | 90  | 1400      |
| SS-312J-08 | M8  | 165    | 250 | 11.8 | 15.5 | 105 | 2200      |



BOTTLESCREW - TOGGLE & TOGGLE AISI 316

| CODE       | DIA | LENGTH |     | A   | H  | L   | TDL<br>KG |
|------------|-----|--------|-----|-----|----|-----|-----------|
|            |     | MIN    | MAX |     |    |     |           |
| SS-3125-06 | M6  | 150    | 200 | 7.8 | 15 | 90  | 900       |
| SS-3125-08 | M8  | 185    | 260 | 11  | 17 | 104 | 1650      |



BOTTLESCREW - SWAGELESS AISI 316

| CODE        | THREAD<br>SIZE | TO<br>SUIT<br>WIRE | L1  |     | H  | A | PIN<br>DIA | TDL<br>KG |
|-------------|----------------|--------------------|-----|-----|----|---|------------|-----------|
|             |                |                    | MIN | MAX |    |   |            |           |
| SS-8014-603 | M6             | 1/8"               | 163 | 245 | 13 | 8 | 6          | 600       |

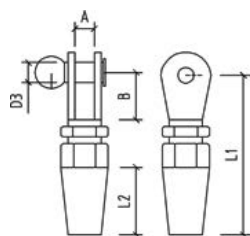

FORK TERMINAL - SWAGELESS AISI 316

| CODE       | WIRE<br>DIA | A | B  | D3 | L1 | L2 |
|------------|-------------|---|----|----|----|----|
| SS-8012-03 | 1/8"        | 9 | 19 | 5  | 50 | 19 |



# STAINLESS STEEL FITTINGS

Telephone (07) 55 93 56 88

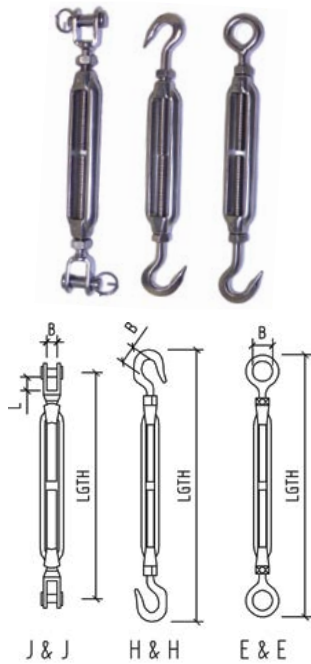

TURNBUCKLES - OPEN BODY - WITH LOCK NUTS

| CODE        | DIA<br>mm | STYLE | LENGTH |     | B  | L  | TDL<br>KG |
|-------------|-----------|-------|--------|-----|----|----|-----------|
|             |           |       | MIN    | MAX |    |    |           |
| SS-311E-04  | 4         | E & E | 98     | 135 | 8  |    | 475       |
| SS-311H-04  | 4         | H & H | 98     | 135 | 7  |    | 100       |
| SS-311HE-04 | 4         | H & E | 98     | 135 | 8  |    | 100       |
| SS-311E-05  | 5         | E & E | 120    | 170 | 8  |    | 680       |
| SS-311H-05  | 5         | H & H | 120    | 170 | 7  |    | 130       |
| SS-311HE-05 | 5         | H & E | 120    | 170 | 7  |    | 130       |
| SS-311J-05  | 5         | J & J | 120    | 160 | 6  | 10 | 680       |
| SS-311E-06  | 6         | E & E | 150    | 220 | 10 |    | 1500      |
| SS-311H-06  | 6         | H & H | 160    | 220 | 9  |    | 350       |
| SS-311HE-06 | 6         | H & E | 155    | 220 | 9  |    | 350       |
| SS-311J-06  | 6         | J & J | 150    | 200 | 7  | 9  | 1500      |



## GROMMETS

Bridco have a range of grommets to be used when passing wire through steel, aluminium or even timber posts. These UV stabilised, high density polythene grommets give a neat appearance as well as protection from chafe and electrolysis.

For further information on sizes and dimensions please refer to the Bridco product catalogue or visit our website [www.bridco.com.au](http://www.bridco.com.au) and follow the link to download the catalogue.





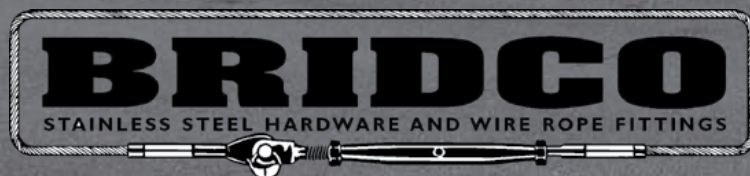

Importers and Wholesalers of Stainless Steel Hardware and Wire Rope Fittings,  
Swage Presses and Associated Machinery.





BRIDCO  
OFFICE &  
SHOWROOM

BRIDCO





37 TAREE STREET  
BURLEIGH QLD 4220

TELEPHONE (07) 55 935 688  
FAX (07) 55 935 872

WEB: [www.bridco.com.au](http://www.bridco.com.au)  
EMAIL: [bridge@bridco.com.au](mailto:bridge@bridco.com.au)

B R I D G E   &   C O M P A N Y   P T Y   L T D

A white silhouette of the map of Australia is centered on a black background. The text "We Have," and "Distributors Throughout Australia" is placed within the map's outline.

We Have,  
Distributors Throughout Australia

First Edition - June 2013

Bridge & Company Pty Ltd. ABN 79 010 586 857

